

National Flood Insurance Program

Elevation Certificate and Instructions

2023 EDITION



FEMA

ELEVATION CERTIFICATE AND INSTRUCTIONS

PAPERWORK REDUCTION ACT NOTICE

Public reporting burden for this data collection is estimated to average 3.75 hours per response. The burden estimate includes the time for reviewing instructions, searching existing data sources, gathering and maintaining the data needed, and completing and submitting this form. You are not required to respond to this collection of information unless a valid OMB control number is displayed on this form. Send comments regarding the accuracy of the burden estimate and any suggestions for reducing the burden to: Information Collections Management, Department of Homeland Security, Federal Emergency Management Agency, 500 C Street SW, Washington, DC 20742, Paperwork Reduction Project (1660-0008). **NOTE: Do not send your completed form to this address.**

PRIVACY ACT STATEMENT

Authority: Title 44 CFR § 61.7 and 61.8.

Principal Purpose(s): This information is being collected for the primary purpose of documenting compliance with National Flood Insurance Program (NFIP) floodplain management ordinances for new or substantially improved structures in designated Special Flood Hazard Areas. This form may also be used as an optional tool for a Letter of Map Amendment (LOMA), Conditional LOMA (CLOMA), Letter of Map Revision Based on Fill (LOMR-F), or Conditional LOMR-F (CLOMR-F), or for flood insurance rating purposes in any flood zone.

Routine Use(s): The information on this form may be disclosed as generally permitted under 5 U.S.C. § 552a(b) of the Privacy Act of 1974, as amended. This includes using this information as necessary and authorized by the routine uses published in DHS/ FEMA-003 – *National Flood Insurance Program Files System of Records Notice 79 Fed. Reg. 28747 (May 19, 2014)* and upon written request, written consent, by agreement, or as required by law.

Disclosure: The disclosure of information on this form is voluntary; however, failure to provide the information requested may impact the flood insurance premium through the NFIP. Information will only be released as permitted by law.

PURPOSE OF THE ELEVATION CERTIFICATE

The Elevation Certificate is an important administrative tool of the NFIP. It can be used to provide elevation information necessary to ensure compliance with community floodplain management ordinances, to inform the proper insurance premium, and to support a request for a LOMA, CLOMA, LOMR-F, or CLOMR-F.

The Elevation Certificate is used to document floodplain management compliance for Post-Flood Insurance Rate Map (FIRM) buildings, which are buildings constructed after publication of the FIRM, located in flood Zones A1–A30, AE, AH, AO, A (with Base Flood Elevation (BFE)), VE, V1–V30, V (with BFE), AR, AR/A, AR/AE, AR/A1–A30, AR/AH, AR/AO, and A99. It may also be used to provide elevation information for Pre-FIRM buildings or buildings in any flood zone.

As part of the agreement for making flood insurance available in a community, the NFIP requires the community to adopt floodplain management regulations that specify minimum requirements for reducing flood losses. One such requirement is for the community to obtain the elevation of the lowest floor (including basement) of all new and substantially improved buildings, and maintain a record of such information. The Elevation Certificate provides a way for a community to document compliance with the community's floodplain management ordinance.

Use of this certificate does not provide a waiver of the flood insurance purchase requirement. Only a LOMA or LOMR-F from the Federal Emergency Management Agency (FEMA) can amend the FIRM and remove the federal mandate for a lending institution to require the purchase of flood insurance. However, the lending institution has the option of requiring flood insurance even if a LOMA/LOMR-F has been issued by FEMA. The Elevation Certificate may be used to support a LOMA, CLOMA, LOMR-F, or CLOMR-F request. Lowest Adjacent Grade (LAG) elevations certified by a land surveyor, engineer, or architect, as authorized by state law, will be required if the certificate is used to support a LOMA, CLOMA, LOMR-F, or CLOMR-F request. A LOMA, CLOMA, LOMR-F, or CLOMR-F request must be submitted with either a completed FEMA MT-EZ or MT-1 application package, whichever is appropriate. If the certificate will only be completed to support a LOMA, CLOMA, LOMR-F, or CLOMR-F request, there is an option to document the certified LAG elevation on the Elevation Form included in the MT-EZ and MT-1 application.

This certificate is used only to certify building elevations. A separate certificate is required for floodproofing. Under the NFIP, non-residential buildings can be floodproofed up to or above the BFE. A floodproofed building is a building that has been designed and constructed to be watertight (substantially impermeable to floodwaters) below the BFE. Floodproofing of residential buildings is not permitted under the NFIP unless FEMA has granted the community an exception for residential floodproofed basements. The community must adopt standards for design and construction of floodproofed basements before FEMA will grant a basement exception. For both floodproofed non-residential buildings and residential floodproofed basements in communities that have been granted an exception by FEMA, a floodproofing certificate is required.

The expiration date on the form herein does not apply to certified and completed Elevation Certificates, as a completed Elevation Certificate does not expire, unless there is a physical change to the building that invalidates information in Section A Items A8 or A9, Section C, Section E, or Section H. In addition, this form is intended for the specific building referenced in Section A and is not invalidated by the transfer of building ownership.

Additional guidance can be found in FEMA Publication 467-1, *Floodplain Management Bulletin: Elevation Certificate*.

U.S. DEPARTMENT OF HOMELAND SECURITY
Federal Emergency Management Agency
National Flood Insurance Program

OMB Control No. 1660-0008
Expiration Date: 06/30/2026

ELEVATION CERTIFICATE

IMPORTANT: MUST FOLLOW THE INSTRUCTIONS ON INSTRUCTION PAGES 1-11

Copy all pages of this Elevation Certificate and all attachments for (1) community official, (2) insurance agent/company, and (3) building owner.

SECTION A – PROPERTY INFORMATION		FOR INSURANCE COMPANY USE
A1. Building Owner's Name: <u>MICHEAL R BRITTON</u>		Policy Number: _____
A2. Building Street Address (including Apt., Unit, Suite, and/or Bldg. No.) or P.O. Route and Box No.: <u>1808 ARNOLDS CREEK ROAD</u>		Company NAIC Number: _____
City: <u>WEST UNION</u> State: <u>WV</u> ZIP Code: <u>26456</u>		
A3. Property Description (e.g., Lot and Block Numbers or Legal Description) and/or Tax Parcel Number: <u>WEST UNION DISTRICT, TAX MAP 19, PARCEL 15 (ARNOLDS CREEK 136.56AC; 1/2 INT)</u>		
A4. Building Use (e.g., Residential, Non-Residential, Addition, Accessory, etc.): <u>RESIDENTIAL</u>		
A5. Latitude/Longitude: Lat. <u>39.256072</u> Long. <u>-80.809689</u> Horiz. Datum: <input type="checkbox"/> NAD 1927 <input checked="" type="checkbox"/> NAD 1983 <input type="checkbox"/> WGS 84		
A6. Attach at least two and when possible four clear color photographs (one for each side) of the building (see Form pages 7 and 8).		
A7. Building Diagram Number: <u>8</u>		
A8. For a building with a crawlspace or enclosure(s):		
a) Square footage of crawlspace or enclosure(s): <u>960</u> sq. ft.		
b) Is there at least one permanent flood opening on two different sides of each enclosed area? <input checked="" type="checkbox"/> Yes <input type="checkbox"/> No <input type="checkbox"/> N/A		
c) Enter number of permanent flood openings in the crawlspace or enclosure(s) within 1.0 foot above adjacent grade: Non-engineered flood openings: <u>0</u> Engineered flood openings: <u>N/A</u>		
d) Total net open area of non-engineered flood openings in A8.c: <u>180</u> sq. in.		
e) Total rated area of engineered flood openings in A8.c (attach documentation – see Instructions): <u>N/A</u> sq. ft.		
f) Sum of A8.d and A8.e rated area (if applicable – see Instructions): <u>180</u> sq. ft.		
A9. For a building with an attached garage:		
a) Square footage of attached garage: <u>N/A</u> sq. ft.		
b) Is there at least one permanent flood opening on two different sides of the attached garage? <input type="checkbox"/> Yes <input type="checkbox"/> No <input checked="" type="checkbox"/> N/A		
c) Enter number of permanent flood openings in the attached garage within 1.0 foot above adjacent grade: Non-engineered flood openings: <u>N/A</u> Engineered flood openings: <u>N/A</u>		
d) Total net open area of non-engineered flood openings in A9.c: <u>N/A</u> sq. in.		
e) Total rated area of engineered flood openings in A9.c (attach documentation – see Instructions): <u>N/A</u> sq. ft.		
f) Sum of A9.d and A9.e rated area (if applicable – see Instructions): <u>N/A</u> sq. ft.		

SECTION B – FLOOD INSURANCE RATE MAP (FIRM) INFORMATION

B1.a. NFIP Community Name: <u>DODDRIDGE COUNTY</u>		B1.b. NFIP Community Identification Number: <u>540024</u>	
B2. County Name: <u>DODDRIDGE</u>	B3. State: <u>WV</u>	B4. Map/Panel No.: <u>120</u>	B5. Suffix: <u>C</u>
B6. FIRM Index Date: <u>10/04/2011</u>		B7. FIRM Panel Effective/Revised Date: <u>10/04/2011</u>	
B8. Flood Zone(s): <u>A</u>		B9. Base Flood Elevation(s) (BFE) (Zone AO, use Base Flood Depth): <u>836.4</u>	
B10. Indicate the source of the BFE data or Base Flood Depth entered in Item B9: <input type="checkbox"/> FIS <input type="checkbox"/> FIRM <input type="checkbox"/> Community Determined <input checked="" type="checkbox"/> Other: <u>WV FLOOD TOOL ADVISORY FLOOD HEIGHT (AFH)</u>			
B11. Indicate elevation datum used for BFE in Item B9: <input type="checkbox"/> NGVD 1929 <input checked="" type="checkbox"/> NAVD 1988 <input type="checkbox"/> Other/Source: _____			
B12. Is the building located in a Coastal Barrier Resources System (CBRS) area or Otherwise Protected Area (OPA)? <input type="checkbox"/> Yes <input checked="" type="checkbox"/> No Designation Date: _____ <input type="checkbox"/> CBRS <input type="checkbox"/> OPA			
B13. Is the building located seaward of the Limit of Moderate Wave Action (LiMWA)? <input type="checkbox"/> Yes <input checked="" type="checkbox"/> No			

ELEVATION CERTIFICATE

IMPORTANT: MUST FOLLOW THE INSTRUCTIONS ON INSTRUCTION PAGES 1-11

Building Street Address (including Apt., Unit, Suite, and/or Bldg. No.) or P.O. Route and Box No.:

1808 ARNOLDS CREEK ROAD

City: WEST UNION

State: WV

ZIP Code: 26456

FOR INSURANCE COMPANY USE

Policy Number: _____

Company NAIC Number: _____

SECTION C – BUILDING ELEVATION INFORMATION (SURVEY REQUIRED)

C1. Building elevations are based on: ☒ Construction Drawings* ☐ Building Under Construction* ☐ Finished Construction

*A new Elevation Certificate will be required when construction of the building is complete.

C2. Elevations – Zones A1–A30, AE, AH, AO, A (with BFE), VE, V1–V30, V (with BFE), AR, AR/A, AR/AE, AR/A1–A30, AR/AH, AR/AO, A99. Complete Items C2.a–h below according to the Building Diagram specified in Item A7. In Puerto Rico only, enter meters.

Benchmark Utilized: OPUS

Vertical Datum: NAVD88

Indicate elevation datum used for the elevations in items a) through h) below.

☐ NGVD 1929 ☒ NAVD 1988 ☐ Other: _____

Datum used for building elevations must be the same as that used for the BFE. Conversion factor used?

☐ Yes ☒ No

If Yes, describe the source of the conversion factor in the Section D Comments area.

Check the measurement used:

a) Top of bottom floor (including basement, crawlspace, or enclosure floor):

838.0

☒ feet ☐ meters

b) Top of the next higher floor (see Instructions):

841.3

☒ feet ☐ meters

c) Bottom of the lowest horizontal structural member (see Instructions):

N/A

☐ feet ☐ meters

d) Attached garage (top of slab):

N/A

☐ feet ☐ meters

e) Lowest elevation of Machinery and Equipment (M&E) servicing the building (describe type of M&E and location in Section D Comments area):

838.0

☒ feet ☐ meters

f) Lowest Adjacent Grade (LAG) next to building: ☒ Natural ☐ Finished

838.0

☒ feet ☐ meters

g) Highest Adjacent Grade (HAG) next to building: ☒ Natural ☐ Finished

838.3

☒ feet ☐ meters

h) Finished LAG at lowest elevation of attached deck or stairs, including structural support:

837.6

☒ feet ☐ meters

SECTION D – SURVEYOR, ENGINEER, OR ARCHITECT CERTIFICATION

This certification is to be signed and sealed by a land surveyor, engineer, or architect authorized by state law to certify elevation information. I certify that the information on this Certificate represents my best efforts to interpret the data available. I understand that any false statement may be punishable by fine or imprisonment under 18 U.S. Code, Section 1001.

Were latitude and longitude in Section A provided by a licensed land surveyor? ☒ Yes ☐ No

☒ Check here if attachments and describe in the Comments area.

Certifier's Name: GARRETT A. DEVERICKS

License Number: 2468

Title: OWNER/ PROFESSIONAL SURVEYOR

Company Name: DEVERICKS LAND SURVEYING, LLC.

Address: P.O. BOX 93

City: SALEM

State: WV

ZIP Code: 26426

Telephone: (304) 695-3416

Ext.: _____

Email: DEVERICKSPS2468@GMAIL.COM

Signature: 

Date: 1/24/2026

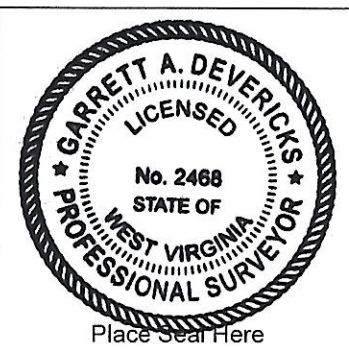

Copy all pages of this Elevation Certificate and all attachments for (1) community official, (2) insurance agent/company, and (3) building owner.

Comments (including source of conversion factor in C2; type of equipment and location per C2.e; and description of any attachments):

FEMA FIRMeTette & WV Flood Tool Map attached

OPUS report attached

2 vent openings on rear of building (1 under deck), 2 vents on right side under deck - none are within 1' of grade

Vents are Model Number PLSLBL from Menard's per home owner

House is block foundation with crawlspace, 24'x40' with 8' deck off of three sides.

ELEVATION CERTIFICATE

IMPORTANT: MUST FOLLOW THE INSTRUCTIONS ON INSTRUCTION PAGES 1-11

Building Street Address (including Apt., Unit, Suite, and/or Bldg. No.) or P.O. Route and Box No.:
1808 ARNOLDS CREEK ROAD

City: WEST UNION State: WV ZIP Code: 26456

FOR INSURANCE COMPANY USE

Policy Number: _____

Company NAIC Number: _____

SECTION E – BUILDING MEASUREMENT INFORMATION (SURVEY NOT REQUIRED) FOR ZONE AO, ZONE AR/AO, AND ZONE A (WITHOUT BFE)

For Zones AO, AR/AO, and A (without BFE), complete Items E1–E5. For Items E1–E4, use natural grade, if available. If the Certificate is intended to support a Letter of Map Change request, complete Sections A, B, and C. Check the measurement used. In Puerto Rico only, enter meters.

Building measurements are based on: ☐ Construction Drawings* ☐ Building Under Construction* ☒ Finished Construction

*A new Elevation Certificate will be required when construction of the building is complete.

E1. Provide measurements (C.2.a in applicable Building Diagram) for the following and check the appropriate boxes to show whether the measurement is above or below the natural HAG and the LAG.

a) Top of bottom floor (including basement, crawlspace, or enclosure) is: _____ 0.3 ☒ feet ☐ meters ☐ above or ☒ below the HAG.

b) Top of bottom floor (including basement, crawlspace, or enclosure) is: _____ 0.0 ☒ feet ☐ meters ☐ above or ☒ below the LAG.

E2. For Building Diagrams 6–9 with permanent flood openings provided in Section A Items 8 and/or 9 (see pages 1–2 of Instructions), the next higher floor (C2.b in applicable Building Diagram) of the building is: _____ 3.0 ☒ feet ☐ meters ☒ above or ☐ below the HAG.

E3. Attached garage (top of slab) is: _____ N/A ☐ feet ☐ meters ☐ above or ☐ below the HAG.

E4. Top of platform of machinery and/or equipment servicing the building is: _____ 0.3 ☒ feet ☐ meters ☐ above or ☒ below the HAG.

E5. Zone AO only: If no flood depth number is available, is the top of the bottom floor elevated in accordance with the community's floodplain management ordinance? ☐ Yes ☐ No ☐ Unknown The local official must certify this information in Section G.

SECTION F – PROPERTY OWNER (OR OWNER'S AUTHORIZED REPRESENTATIVE) CERTIFICATION

The property owner or owner's authorized representative who completes Sections A, B, and E for Zone A (without BFE) or Zone AO must sign here. *The statements in Sections A, B, and E are correct to the best of my knowledge*

☐ Check here if attachments and describe in the Comments area.

Property Owner or Owner's Authorized Representative Name: _____

Address: _____

City: _____ State: _____ ZIP Code: _____

Telephone: _____ Ext.: _____ Email: _____

Signature: _____ Date: _____

Comments:

ELEVATION CERTIFICATE

IMPORTANT: MUST FOLLOW THE INSTRUCTIONS ON INSTRUCTION PAGES 1-11

Building Street Address (including Apt., Unit, Suite, and/or Bldg. No.) or P.O. Route and Box No.:
1808 ARNOLDS CREEK ROAD

City: WEST UNION State: WV ZIP Code: 26456

FOR INSURANCE COMPANY USE

Policy Number: _____

Company NAIC Number: _____

SECTION G – COMMUNITY INFORMATION (RECOMMENDED FOR COMMUNITY OFFICIAL COMPLETION)

The local official who is authorized by law or ordinance to administer the community's floodplain management ordinance can complete Section A, B, C, E, G, or H of this Elevation Certificate. Complete the applicable item(s) and sign below when:

- G1. ☐ The information in Section C was taken from other documentation that has been signed and sealed by a licensed surveyor, engineer, or architect who is authorized by state law to certify elevation information. (Indicate the source and date of the elevation data in the Comments area below.)
- G2.a. ☐ A local official completed Section E for a building located in Zone A (without a BFE), Zone AO, or Zone AR/AO, or when item E5 is completed for a building located in Zone AO.
- G2.b. ☐ A local official completed Section H for insurance purposes.
- G3. ☐ In the Comments area of Section G, the local official describes specific corrections to the information in Sections A, B, E and H.
- G4. ☐ The following information (Items G5–G11) is provided for community floodplain management purposes.
- G5. Permit Number: _____ G6. Date Permit Issued: _____
- G7. Date Certificate of Compliance/Occupancy Issued: _____
- G8. This permit has been issued for: ☐ New Construction ☐ Substantial Improvement
- G9.a. Elevation of as-built lowest floor (including basement) of the building: _____ ☐ feet ☐ meters Datum: _____
- G9.b. Elevation of bottom of as-built lowest horizontal structural member: _____ ☐ feet ☐ meters Datum: _____
- G10.a. BFE (or depth in Zone AO) of flooding at the building site: _____ ☐ feet ☐ meters Datum: _____
- G10.b. Community's minimum elevation (or depth in Zone AO) requirement for the lowest floor or lowest horizontal structural member: _____ ☐ feet ☐ meters Datum: _____
- G11. Variance issued? ☐ Yes ☐ No If yes, attach documentation and describe in the Comments area.

The local official who provides information in Section G must sign here. *I have completed the information in Section G and certify that it is correct to the best of my knowledge. If applicable, I have also provided specific corrections in the Comments area of this section.*

Local Official's Name: _____ Title: _____

NFIP Community Name: _____

Telephone: _____ Ext.: _____ Email: _____

Address: _____

City: _____ State: _____ ZIP Code: _____

Signature: _____ Date: _____

Comments (including type of equipment and location, per C2.e; description of any attachments; and corrections to specific information in Sections A, B, D, E, or H):

ELEVATION CERTIFICATE

IMPORTANT: MUST FOLLOW THE INSTRUCTIONS ON INSTRUCTION PAGES 1-11

Building Street Address (including Apt., Unit, Suite, and/or Bldg. No.) or P.O. Route and Box No.: 1808 ARNOLDS CREEK ROAD	FOR INSURANCE COMPANY USE
City: WEST UNION State: WV ZIP Code: 26456	Policy Number: _____ Company NAIC Number: _____

SECTION H – BUILDING'S FIRST FLOOR HEIGHT INFORMATION FOR ALL ZONES (SURVEY NOT REQUIRED) (FOR INSURANCE PURPOSES ONLY)

The property owner, owner's authorized representative, or local floodplain management official may complete Section H for all flood zones to determine the building's first floor height for insurance purposes. Sections A, B, and I must also be completed. Enter heights to the nearest tenth of a foot (nearest tenth of a meter in Puerto Rico). **Reference the Foundation Type Diagrams (at the end of Section H Instructions) and the appropriate Building Diagrams (at the end of Section I Instructions) to complete this section.**

H1. Provide the height of the top of the floor (as indicated in Foundation Type Diagrams) above the Lowest Adjacent Grade (LAG):

a) For Building Diagrams 1A, 1B, 3, and 5–8. Top of bottom floor (include above-grade floors only for buildings with crawlspaces or enclosure floors) is: _____ 0.0 ☒ feet ☐ meters ☒ above the LAG

b) For Building Diagrams 2A, 2B, 4, and 6–9. Top of next higher floor (i.e., the floor above basement, crawlspace, or enclosure floor) is: _____ 3.3 ☒ feet ☐ meters ☒ above the LAG

H2. Is all Machinery and Equipment servicing the building (as listed in Item H2 instructions) elevated to or above the floor indicated by the H2 arrow (shown in the Foundation Type Diagrams at end of Section H instructions) for the appropriate Building Diagram?
☐ Yes ☒ No

SECTION I – PROPERTY OWNER (OR OWNER'S AUTHORIZED REPRESENTATIVE) CERTIFICATION

The property owner or owner's authorized representative who completes Sections A, B, and H must sign here. *The statements in Sections A, B, and H are correct to the best of my knowledge.* **Note:** If the local floodplain management official completed Section H, they should indicate in Item G2.b and sign Section G.

☐ Check here if attachments are provided (including required photos) and describe each attachment in the Comments area.

Property Owner or Owner's Authorized Representative Name: _____

Address: _____

City: _____ State: _____ ZIP Code: _____

Telephone: _____ Ext.: _____ Email: _____

Signature: _____ Date: _____

Comments:

Utilities Comment:

AC/Furnace is outside slightly elevated above HAG/LAG. Water bladder tank is in crawlspace on grade equal to LAG

ELEVATION CERTIFICATE

IMPORTANT: MUST FOLLOW THE INSTRUCTIONS ON INSTRUCTION PAGES 1-11

BUILDING PHOTOGRAPHS

See Instructions for Item A6.

Building Street Address (including Apt., Unit, Suite, and/or Bldg. No.) or P.O. Route and Box No.:
1808 ARNOLDS CREEK ROAD

City: WEST UNION State: WV ZIP Code: 26456

FOR INSURANCE COMPANY USE

Policy Number: _____

Company NAIC Number: _____

Instructions: Insert below at least two and when possible four photographs showing each side of the building (for example, may only be able to take front and back pictures of townhouses/rowhouses). Identify all photographs with the date taken and "Front View," "Rear View," "Right Side View," or "Left Side View." Photographs must show the foundation. When flood openings are present, include at least one close-up photograph of representative flood openings or vents, as indicated in Sections A8 and A9.



Photo One

Photo One Caption: FRONT - EAST FACING SIDE - 1/17/26

Clear Photo One



Photo Two

Photo Two Caption: LEFT SIDE - SOUTH FACING SIDE - 1/17/26

Clear Photo Two

ELEVATION CERTIFICATE

IMPORTANT: MUST FOLLOW THE INSTRUCTIONS ON INSTRUCTION PAGES 1-11

BUILDING PHOTOGRAPHS

Continuation Page

Building Street Address (including Apt., Unit, Suite, and/or Bldg. No.) or P.O. Route and Box No.:
1808 ARNOLDS CREEK ROAD

City: WEST UNION State: WV ZIP Code: 26456

FOR INSURANCE COMPANY USE

Policy Number: _____

Company NAIC Number: _____

Insert the third and fourth photographs below. Identify all photographs with the date taken and "Front View," "Rear View," "Right Side View," or "Left Side View." When flood openings are present, include at least one close-up photograph of representative flood openings or vents, as indicated in Sections A8 and A9.



Photo Three

Photo Three Caption: REAR - WEST FACING SIDE - 1/17/26

Clear Photo Three



Photo Four

Photo Four Caption: RIGHT SIDE - NORTH FACING SIDE - 1/17/26

Clear Photo Four

National Flood Hazard Layer FIRMette

80°48'53"W 39°15'36"N



Legend

SEE FIS REPORT FOR DETAILED LEGEND AND INDEX MAP FOR FIRM PANEL LAYOUT

Without Base Flood Elevation (BFE)
Zone A, V, AE

With BFE or Depth *Zone AE, AO, AH, VE, AR*

Regulatory Floodway

0.2% Annual Chance Flood Hazard, Areas of 1% annual chance flood with average depth less than one foot or with drainage areas of less than one square mile *Zone X*

Future Conditions 1% Annual Chance Flood Hazard *Zone X*

Area with Reduced Flood Risk due to Levee. See Notes. *Zone X*

Area with Flood Risk due to Levee *Zone D*

NO SCREEN

Area of Minimal Flood Hazard *Zone X*

Effective LOMRS

Area of Undetermined Flood Hazard *Zone L*

Channel, Culvert, or Storm Sewer

Levee, Dike, or Floodwall

Cross Sections with 1% Annual Chance Water Surface Elevation

Coastal Transect

Base Flood Elevation Line (BFE)

Limit of Study

Jurisdiction Boundary

Coastal Transect Baseline

Profile Baseline

Hydrographic Feature

Digital Data Available

No Digital Data Available

Unmapped

MAP PANELS

The pin displayed on the map is an approximate point selected by the user and does not represent an authoritative property location.

This map complies with FEMA's standards for the use of digital flood maps if it is not void as described below. The basemap shown complies with FEMA's basemap accuracy standards.

The flood hazard information is derived directly from the authoritative NFHL web services provided by FEMA. This map was exported on **1/19/2026 at 11:24 AM** and does not reflect changes or amendments subsequent to this date and time. The NFHL and effective information may change or become superseded by new data over time.

This map image is void if the one or more of the following map elements do not appear: basemap imagery, flood zone labels, legend, scale bar, map creation date, community identifiers, FIRM panel number, and FIRM effective date. Map images for unmapped and unmodernized areas cannot be used for regulatory purposes.

Racemap Imagery Source: USGS National Map 2023

Britton - 1808 Arnolds Creek



This map is not the official regulatory FIRM or DFIRM. Its purpose is to assist with determining potential flood risk for the selected location.

<div>H I G H</div> <div><div>Zone AE</div>1-Percent-Annual-Chance Flood Hazard Area With Base Flood Elevation (BFE)</div> <div><div>Floodway</div>Regulatory Floodway in AE Zone</div>		<div><div>Flood Info Location</div><div>Map created on 1/19/2026</div></div>	
<div>R I S K</div> <div><div>Zone A</div>1-Percent-Annual-Chance Flood Hazard Area Without BFE (may have Advisory Flood Heights)</div> <div><div>Advisory</div>1-Percent-Annual-Chance High Risk Advisory</div>		<div>User Notes</div>	
<div>Download the Full Legend for all flood tool symbols https://www.mapwv.gov/flood/map/docs/wv_flood_tool_legend.pdf</div>		<div>Flood Hazard Area</div>	Location is WITHIN the FEMA 100-year floodplain. Advisory Flood Heights available.
		<div>Flood Zone</div>	A (Advisory Flood Heights available)
		<div>Stream</div>	Right Fork Arnold Creek
		<div>Watershed (HUC8)</div>	Little Musringum-Middle Island (5030201)
		<div>Flood Height</div>	About 836.4 ft (Source: AFH) NAVD88
		<div>Water Depth</div>	
		<div>Elevation</div>	838.7 ft (Source: FEMA 2018-20) (NAVD88)
		<div>Community & ID</div>	Doddridge County (ID: 540024)
		<div>FEMA Map & Date</div>	54017C0120C; Effective Date: 10/4/2011
		<div>Location (lat, long)</div>	(39.256054, -80.809649) (WGS84)
		<div>Parcel ID</div>	09-08-0019-0015-0000
		<div>E-911 Address</div>	multiple addresses
<div>Disclaimer:</div> <div>The online map is for use in administering the National Flood Insurance Program. It does not necessarily identify all areas subject to flooding, particularly from local drainage sources of small size. Refer to the official Flood Insurance Study (FIS) for detailed flood elevation data in flood profiles and data tables. WV Flood Tool (https://www.mapwv.gov/flood) is supported by FEMA, WV NFIP Office, and WV GIS Technical Center.</div>			



Garrett Devericks <garrett@triplehenterprises.net>

OPUS solution : 1 TR5065620455632

1 message

opus <opus@ngs.noaa.gov>
 Reply-To: ngs.opus@noaa.gov
 To: garrett@triplehenterprises.net

Tue, Jan 20, 2026 at 6:50 AM

FILE: 1 TR5065620455632

NGS OPUS SOLUTION REPORT
 =====

All computed coordinate accuracies are listed as peak-to-peak values.
 For additional information: <https://www.ngs.noaa.gov/OPUS/about.jsp#accuracy>

USER: garrett@triplehenterprises.net DATE: January 20, 2026
 RINEX FILE: 1__017n.26o TIME: 11:49:53 UTC

SOFTWARE: page5 2008.25 [master262.pl](#) 160321 START: 2026/01/17 13:05:00
 EPHEMERIS: igr24016.eph [rapid] STOP: 2026/01/17 15:07:00
 NAV FILE: brdc0170.26n OBS USED: 3067 / 4026 : 76%
 ANT NAME: TRMR8_GNSS NONE # FIXED AMB: 26 / 27 : 96%
 ARP HEIGHT: 1.4722 OVERALL RMS: 0.016(m)

REF FRAME: NAD_83(2011)(EPOCH:2010.0000) ITRF2020 (EPOCH:2026.0454)

X:	789886.917(m)	0.011(m)	789885.926(m)	0.011(m)
Y:	-4882072.854(m)	0.091(m)	-4882071.431(m)	0.091(m)
Z:	4014512.247(m)	0.070(m)	4014512.186(m)	0.070(m)

LAT:	39 15 21.89938	0.004(m)	39 15 21.92994	0.004(m)
E LON:	279 11 25.56726	0.006(m)	279 11 25.53594	0.006(m)
W LON:	80 48 34.43274	0.006(m)	80 48 34.46406	0.006(m)
EL HGT:	223.076(m)	0.115(m)	221.827(m)	0.115(m)
ORTHO HGT:	256.311(m)	0.150(m)	[NAVD88 (Computed using GEOID18)]	

UTM COORDINATES STATE PLANE COORDINATES

	UTM (Zone 17)	SPC (4701 WV N)
Northing (Y) [meters]	4345212.311	84761.700
Easting (X) [meters]	516430.531	486975.542
Convergence [degrees]	0.12050556	-0.83520556
Point Scale	0.99960332	0.99996146
Combined Factor	0.99956834	0.99992646

US NATIONAL GRID DESIGNATOR: 17SND1643045212(NAD 83)

BASE STATIONS USED

PID	DESIGNATION	LATITUDE	LONGITUDE	DISTANCE(m)
DM2710	WVMZ MOUNT ZION CORS ARP	N385020.043	W0810631.582	53067.1
DR7399	OHWS OHWS WASHINGTON 2 CORS GRP	N392534.540	W0812503.925	55733.2
DP1324	WVHA HARRISVILLE CORS ARP	N391452.262	W0810237.844	20244.3

NEAREST NGS PUBLISHED CONTROL POINT

JX1756	J 319	N391639.240	W0804844.580	2397.5
--------	-------	-------------	--------------	--------

This position and the above vector components were computed without any

~~~~~

 1\_\_\_\_017n.26o.xml  
5K