

**FEDERAL EMERGENCY MANAGEMENT AGENCY  
NATIONAL FLOOD INSURANCE PROGRAM**

O.M.B. No. 3067-0077  
Expires July 31, 2002

# ELEVATION CERTIFICATE

**Important: Read the instructions on pages 1 - 7.**

## SECTION A - PROPERTY OWNER INFORMATION

BUILDING OWNER'S NAME <b>Ronnie and Dawn Lawrence</b>		For Insurance Company Use: Policy Number
BUILDING STREET ADDRESS (Including Apt., Unit, Suite, and/or Bldg. No.) OR P.O. ROUTE AND BOX NO. <b>HC 78 Box 111B</b>		Company NAIC Number
CITY <b>Griffithsville</b>	STATE <b>WV</b>	ZIP CODE <b>25621</b>
PROPERTY DESCRIPTION (Lot and Block Numbers, Tax Parcel Number, Legal Description, etc.) <b>Union District, Tax Map 7, Parcel 11.7</b>		
BUILDING USE (e.g., Residential, Non-residential, Addition, Accessory, etc. Use a Comments area, if necessary.) <b>Residential</b>		
LATITUDE/LONGITUDE (OPTIONAL) (##° - ##' - ###" or ##.####°)	HORIZONTAL DATUM: <input type="checkbox"/> NAD 1927 <input type="checkbox"/> NAD 1983	SOURCE: <input type="checkbox"/> GPS (Type): <input type="checkbox"/> USGS Quad Map <input type="checkbox"/> Other:

## SECTION B - FLOOD INSURANCE RATE MAP (FIRM) INFORMATION

B1. NFIP COMMUNITY NAME & COMMUNITY NUMBER <b>Lincoln County, West Virginia - Unincorporated Areas</b>		B2. COUNTY NAME <b>Lincoln - unincorporated area</b>		B3. STATE <b>WV</b>	
B4. MAP AND PANEL NUMBER <b>540088 0100</b>	B5. SUFFIX <b>B</b>	B6. FIRM INDEX DATE <b>9/18/1987</b>	B7. FIRM PANEL EFFECTIVE/REVISED DATE <b>9/18/1987</b>	B8. FLOOD ZONE(S) <b>A/X</b>	B9. BASE FLOOD ELEVATION(S) (Zone AO, use depth of flooding) <b>N/A</b>

- B10. Indicate the source of the Base Flood Elevation (BFE) data or base flood depth entered in B9.  
☐ FIS Profile ☐ FIRM ☐ Community Determined ☒ Other (Describe): **None provided**
- B11. Indicate the elevation datum used for the BFE in B9: ☐ NGVD 1929 ☐ NAVD 1988 ☒ Other (Describe): **None provided**
- B12. Is the building located in a Coastal Barrier Resources System (CBRS) area or Otherwise Protected Area (OPA)? ☐ Yes ☒ No Designation Date

## SECTION C - BUILDING ELEVATION INFORMATION (SURVEY REQUIRED)

- C1. Building elevations are based on: ☐ Construction Drawings\* ☐ Building Under Construction\* ☒ Finished Construction  
 \*A new Elevation Certificate will be required when construction of the building is complete.
- C2. Building Diagram Number 8 (Select the building diagram most similar to the building for which this certificate is being completed - see pages 6 and 7. If no diagram accurately represents the building, provide a sketch or photograph.)
- C3. Elevations - Zones A1-A30, AE, AH, A (with BFE), VE, V1-V30, V (with BFE), AR, AR/A, AR/AE, AR/A1-A30, AR/AH, AR/AO  
 Complete Items C3-a-i below according to the building diagram specified in Item C2. State the datum used. If the datum is different from the datum used for the BFE in Section B, convert the datum to that used for the BFE. Show field measurements and datum conversion calculation. Use the space provided or the Comments area of Section D or Section G, as appropriate, to document the datum conversion.  
 Datum **NAVD 88** Conversion/Comments
- Elevation reference mark used T 152 Does the elevation reference mark used appear on the FIRM? ☐ Yes ☒ No
- |   |                    |
|---|--------------------|
| <input type="checkbox"/> a) Top of bottom floor (including basement or enclosure)   | <b>698.6</b> ft(m) |
| <input type="checkbox"/> b) Top of next higher floor  | <b>702.5</b> ft(m) |
| <input type="checkbox"/> c) Bottom of lowest horizontal structural member (V zones only)  | <b>n/a</b> ft(m)   |
| <input type="checkbox"/> d) Attached garage (top of slab)   | <b>n/a</b> ft(m)   |
| <input type="checkbox"/> e) Lowest elevation of machinery and/or equipment servicing the building (Describe in a Comments area) | <b>n/a</b> ft(m)   |
| <input type="checkbox"/> f) Lowest adjacent (finished) grade (LAG)  | <b>698.6</b> ft(m) |
| <input type="checkbox"/> g) Highest adjacent (finished) grade (HAG)   | <b>700.6</b> ft(m) |
| <input type="checkbox"/> h) No. of permanent openings (flood vents) within 1 ft. above adjacent grade <u>3</u>                  |                    |
| <input type="checkbox"/> i) Total area of all permanent openings (flood vents) in C3.h <u>338</u> sq. in. (sq. cm)              |                    |

License Number, Embossed Seal, Signature, and Date

**12-5-00**

*Jerome A. Wendell*

## SECTION D - SURVEYOR, ENGINEER, OR ARCHITECT CERTIFICATION

This certification is to be signed and sealed by a land surveyor, engineer, or architect authorized by law to certify elevation information.  
 I certify that the information in Sections A, B, and C on this certificate represents my best efforts to interpret the data available.  
 I understand that any false statement may be punishable by fine or imprisonment under 18 U.S. Code, Section 1001.

CERTIFIER'S NAME **Jerome A. Wendell**

LICENSE NUMBER **787**

TITLE **Professional Land Surveyor**

COMPANY NAME **WenComp Services**

ADDRESS  
**Route 10 Box 131**

CITY  
**Charleston**

STATE  
**WV**

ZIP CODE  
**25312**

SIGNATURE

*Jerome A. Wendell*

DATE  
**12/5/2000**

TELEPHONE  
**(304) 744-1449**

<b>IMPORTANT: In these spaces, copy the corresponding information from Section A.</b>			For Insurance Company Use:
BUILDING STREET ADDRESS (Including Apt., Unit, Suite, and/or Bldg. No.) OR P.O. ROUTE AND BOX NO. HC 78 Box 111B			Policy Number
CITY Griffithville	STATE WV	ZIP CODE 25521	Company NAIC Number

### SECTION D - SURVEYOR, ENGINEER, OR ARCHITECT CERTIFICATION (CONTINUED)

Copy both sides of this Elevation Certificate for (1) community official, (2) insurance agent/company, and (3) building owner.

#### COMMENTS

See attached plat for explanation of zone determination and location of elevations listed in Section C.

☒ Check here if attachments

### SECTION E - BUILDING ELEVATION INFORMATION (SURVEY NOT REQUIRED) FOR ZONE AO AND ZONE A (WITHOUT BFE)

For Zone AO and Zone A (without BFE), complete Items E1 through E4. If the Elevation Certificate is intended for use as supporting information for a LOMA or LOMR-F, Section C must be completed.

- E1. Building Diagram Number 8 (Select the building diagram most similar to the building for which this certificate is being completed – see pages 6 and 7. If no diagram accurately represents the building, provide a sketch or photograph.)
- E2. The top of the bottom floor (including basement or enclosure) of the building is 1 ft (m) 11 in (cm) ☒ above or ☐ below (check one) the highest adjacent grade. (Use natural grade, if available).
- E3. For Building Diagrams 6-8 with openings (see page 7), the next higher floor or elevated floor (elevation b) of the building is 1 ft (m) 11 in (cm) above the highest adjacent grade. Complete items C3.h and C3.i on front of form.
- E4. For Zone AO only: If no flood depth number is available, is the top of the bottom floor elevated in accordance with the community's floodplain management ordinance?  
☐ Yes ☐ No ☐ Unknown. The local official must certify this information in Section G.

### SECTION F - PROPERTY OWNER (OR OWNER'S REPRESENTATIVE) CERTIFICATION

The property owner or owner's authorized representative who completes Sections A, B, C (Items C3.h and C3.i only), and E for Zone A (without a FEMA-issued or community-issued BFE) or Zone AO must sign here. The statements in Sections A, B, C, and E are correct to the best of my knowledge.

PROPERTY OWNER'S OR OWNER'S AUTHORIZED REPRESENTATIVE'S NAME

Jerome A. Wendell

ADDRESS

Route 10, Box 131

SIGNATURE

*Jerome A. Wendell*

COMMENTS

CITY

Charleston

DATE

12/5/2000

STATE

WV

TELEPHONE

(304)744-1449

ZIP CODE

25312

☒ Check here if attachments

### SECTION G - COMMUNITY INFORMATION (OPTIONAL)

The local official who is authorized by law or ordinance to administer the community's floodplain management ordinance can complete Sections A, B, C (or E), and G of this Elevation Certificate. Complete the applicable item(s) and sign below.

- G1. ☐ The information in Section C was taken from other documentation that has been signed and embossed by a licensed surveyor, engineer, or architect who is authorized by state or local law to certify elevation information. (Indicate the source and date of the elevation data in the Comments area below.)
- G2. ☐ A community official completed Section E for a building located in Zone A (without a FEMA-issued or community-issued BFE) or Zone AO.
- G3. ☐ The following information (Items G4-G9) is provided for community floodplain management purposes.

G4. PERMIT NUMBER

G5. DATE PERMIT ISSUED

G6. DATE CERTIFICATE OF COMPLIANCE/OCCUPANCY ISSUED

G7. This permit has been issued for: ☐ New Construction ☐ Substantial Improvement

G8. Elevation of as-built lowest floor (including basement) of the building is:

\_\_\_\_ ft (m)

Datum:

G9. BFE or (in Zone AO) depth of flooding at the building site is:

\_\_\_\_ ft (m)

Datum:

LOCAL OFFICIAL'S NAME

TITLE

COMMUNITY NAME

TELEPHONE

SIGNATURE

DATE

COMMENTS

☐ Check here if attachments

# NOTES

A. This plat only represents an elevation certification survey.

B. The house on this property is located in either Zone A or Zone X per Lincoln County Community-Panel Number 540088 0100 B, dated September 18, 1987. A specific zone determination is not possible due to the limited information available on the Flood Insurance Rate Map. The lack of a base flood elevation on the FIAM makes it difficult to prove either zone as correct.

C. All elevations shown are referenced to NAVD 88, as determined by survey from USGS BM T 152 (1957), as depicted on the Hager, WV 7 1/2' Quadrangle.

D. This elevation certification survey was performed on December 1, 2000.

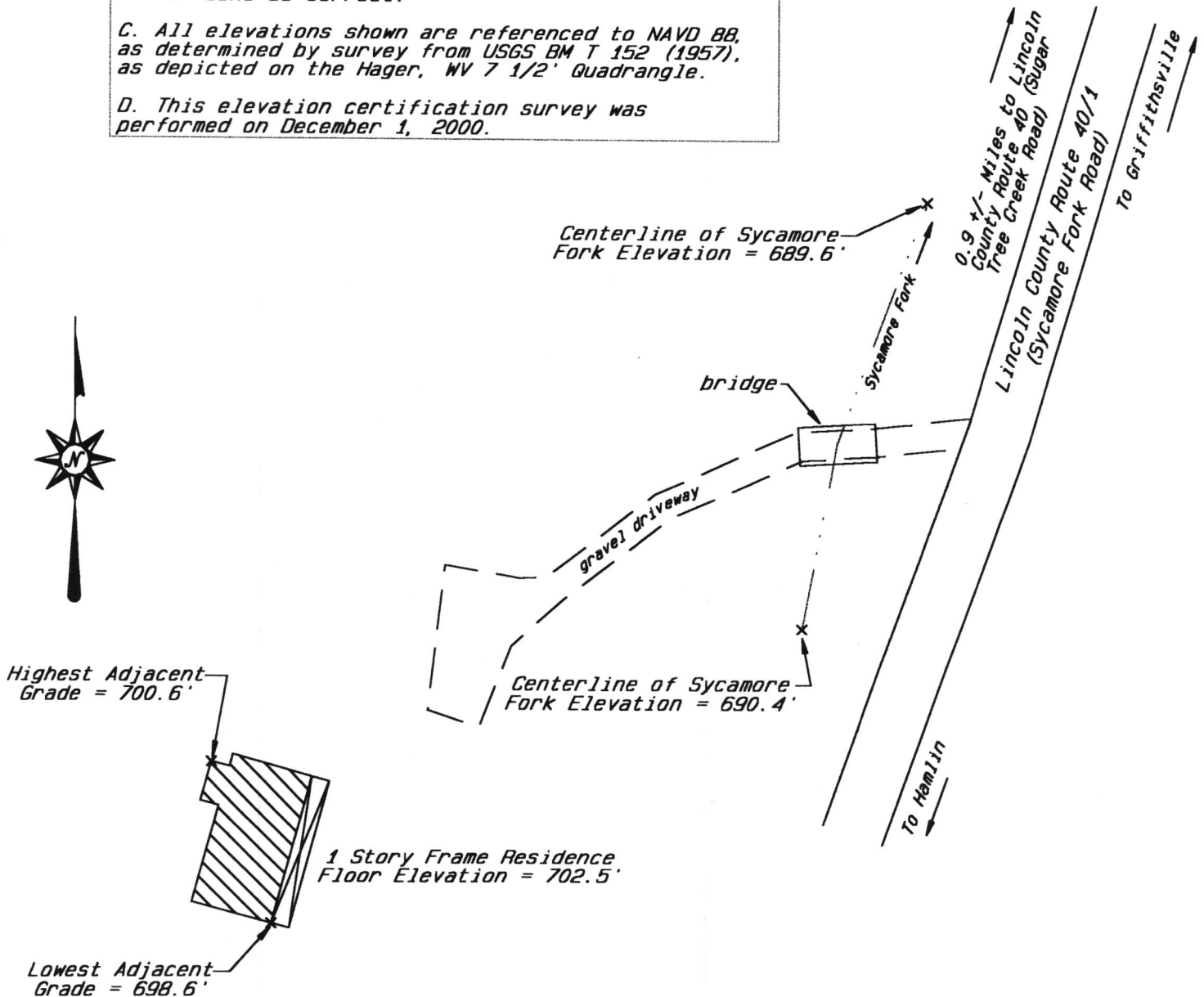

Elevation Certification Sketch for  
Residence of Ronnie and Dawn Lawrence  
Situate on Sycamore Fork of Sugartree Creek  
Union District, Lincoln County, West Virginia  
Scale: 1" = 50'  
December 5, 2000

Graphic Scale (in feet)

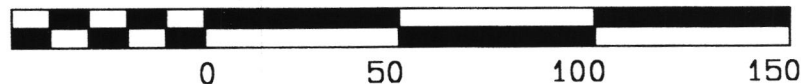

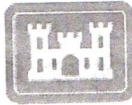

**US Army Corps  
of Engineers.**

**HUNTINGTON DISTRICT, US ARMY CORPS OF ENGINEERS  
FLOODPLAIN MANAGEMENT SERVICES**

502 EIGHTH STREET  
HUNTINGTON, WEST VIRGINIA 25701  
1-866-401-3980 Email: [fpms-lrh@usace.army.mil](mailto:fpms-lrh@usace.army.mil)  
02 October 2015 2:18:20 PM

ID:	1508-1014-3704	DATE IN:	8/10/2015	DATE OUT:	8/13/2015
CONTACT:	Myrtle Lawrence	STATE:	WV		
INTEREST:	Owner and/or Individual	COUNTY:	Lincoln		
PHONE:	304-524-7575	LAT:	38.21032		
REQUEST:	Base Flood Elevation - GIS	LON:	-82.01481		
LOCATION:	208 Sycamore Rd Griffithsville WV 25521				
EXCEPTION:	None noted				

**RESPONSE**

ISSUED BFE:  
699.5 EL FT (NAVD88)

**CALCULATIONS:**

1/9-Arc Second National Elevation Dataset, seamless download,  
<http://nationalmap.usgs.gov>. North American Vertical Datum of 1988  
meters converted to feet by multiplying values by 3.2808399.

Drainage Basin - 1.89 SQ MI  
NSS Crippen & Bue Flood Region "4"  
NSS WV Region "Western"  
PK100: 855.0

EG Slope: 0.012135849  
Mannings N  
Left Channel Bank: 0.05  
Channel: 0.04  
Right Channel Bank: 0.10

WS EL. 699.47

The information provided in this letter reflects FEMA National Flood insurance Program standards. It is recommended that the local floodplain coordinator be contacted for information concerning local policies. Property location was determined from a detailed interview process using the most recent aerial photography.





**US Army Corps  
of Engineers.**

**HUNTINGTON DISTRICT, US ARMY CORPS OF ENGINEERS  
FLOODPLAIN MANAGEMENT SERVICES**

502 EIGHTH STREET  
HUNTINGTON, WEST VIRGINIA 25701  
1-866-401-3980 Email: [fpms-lrh@usace.army.mil](mailto:fpms-lrh@usace.army.mil)  
02 October 2015 2:18:20 PM

**CONFIDENTIAL PRIVILEGED INFORMATION:** The information contained in this communication is confidential and/or privileged, proprietary information that is transmitted solely for the purpose of the intended recipient(s). If the reader of this message is not an intended recipient, or if this message has been inadvertently directed to your attention, you are hereby notified that you have received this communication and any attached document(s) in error, and that any review, dissemination, distribution or copying of this communication is strictly prohibited. If you have received this communication in error, please notify us immediately and destroy all copies of the original communication.

The information obtained from this office is authorized in support of the Federal Emergency Management Agency's (FEMA) National Flood Insurance Program (NFIP) and is authorized by ER 1105-2-100: Planning Guidance Notebook. This information is considered provisional and/or the "best available data" and may be subject to revision. The data is released on the condition that neither the US Army Corps of Engineers nor the United States Government may be held liable for any damages resulting from its use.

Sincerely,

Amy K. Frantz  
Chief, Planning Branch

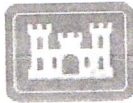

**US Army Corps  
of Engineers.**

**HUNTINGTON DISTRICT, US ARMY CORPS OF ENGINEERS  
FLOODPLAIN MANAGEMENT SERVICES**

502 EIGHTH STREET  
HUNTINGTON, WEST VIRGINIA 25701  
1-866-401-3980 Email: [fpms-lrh@usace.army.mil](mailto:fpms-lrh@usace.army.mil)  
02 October 2015 2:18:20 PM

ID:	1508-1014-3704	DATE IN:	8/10/2015	DATE OUT:	8/13/2015
CONTACT:	Myrtle Lawrence	STATE:	WV		
INTEREST:	Owner and/or Individual	COUNTY:	Lincoln		
PHONE:	304-524-7575	LAT:	38.21032		
REQUEST:	Base Flood Elevation - GIS	LON:	-82.01481		
LOCATION:	208 Sycamore Rd Griffithsville WV 25521				
EXCEPTION:	None noted				

**RESPONSE**

ISSUED BFE:  
699.5 EL FT (NAVD88)

**CALCULATIONS:**

1/9-Arc Second National Elevation Dataset, seamless download,  
<http://nationalmap.usgs.gov>. North American Vertical Datum of 1988  
meters converted to feet by multiplying values by 3.2808399.

Drainage Basin - 1.89 SQ MI  
NSS Crippen & Bue Flood Region "4"  
NSS WV Region "Western"  
PK100: 855.0

EG Slope: 0.012135849  
Mannings N  
Left Channel Bank: 0.05  
Channel: 0.04  
Right Channel Bank: 0.10

WS EL. 699.47

The information provided in this letter reflects FEMA National Flood insurance Program standards. It is recommended that the local floodplain coordinator be contacted for information concerning local policies. Property location was determined from a detailed interview process using the most recent aerial photography.



**US Army Corps  
of Engineers**

**HUNTINGTON DISTRICT, US ARMY CORPS OF ENGINEERS  
FLOODPLAIN MANAGEMENT SERVICES**

502 EIGHTH STREET  
HUNTINGTON, WEST VIRGINIA 25701  
1-866-401-3980 Email: [fpms-lrh@usace.army.mil](mailto:fpms-lrh@usace.army.mil)  
02 October 2015 2:18:20 PM

CONFIDENTIAL PRIVILEGED INFORMATION: The information contained in this communication is confidential and/or privileged, proprietary information that is transmitted solely for the purpose of the intended recipient(s). If the reader of this message is not an intended recipient, or if this message has been inadvertently directed to your attention, you are hereby notified that you have received this communication and any attached document(s) in error, and that any review, dissemination, distribution or copying of this communication is strictly prohibited. If you have received this communication in error, please notify us immediately and destroy all copies of the original communication.

The information obtained from this office is authorized in support of the Federal Emergency Management Agency's (FEMA) National Flood Insurance Program (NFIP) and is authorized by ER 1105-2-100: Planning Guidance Notebook. This information is considered provisional and/or the "best available data" and may be subject to revision. The data is released on the condition that neither the US Army Corps of Engineers nor the United States Government may be held liable for any damages resulting from its use.

Sincerely,

Amy K. Frantz  
Chief, Planning Branch



**US Army Corps  
of Engineers.**

**HUNTINGTON DISTRICT, US ARMY CORPS OF ENGINEERS  
FLOODPLAIN MANAGEMENT SERVICES**

502 EIGHTH STREET  
HUNTINGTON, WEST VIRGINIA 25701  
1-866-401-3980 Email: [fpms-lrh@usace.army.mil](mailto:fpms-lrh@usace.army.mil)  
02 October 2015 2:18:15 PM

---

**REFERENCE NUMBER:**

1508-1014-3704

**REQUEST TYPE:**

Base Flood Elevation - GIS

**REQUEST POINT OF CONTACT:**

Myrtle Lawrence

**CHECK RECEIVED AT:**

US Army Corps of Engineers  
Attn: Planning Branch - FPMS  
502 8th Street  
Huntington, WV 25701

**NOTE:**

Check was delivered to "FAO Huntington District COE"  
and response has been emailed/delivered to contact.  
This request was in support of the Federal Emergency Management  
Agency's (FEMA) National Flood Insurance Program (NFIP)  
as authorized by ER 1105-2-100: Planning Guidance Notebook

**TOTAL PAID:**

\$125.00

Sincerely,

Amy K. Frantz  
Chief, Planning Branch





**US Army Corps  
of Engineers**

**HUNTINGTON DISTRICT, US ARMY CORPS OF ENGINEERS  
FLOODPLAIN MANAGEMENT SERVICES**

502 EIGHTH STREET  
HUNTINGTON, WEST VIRGINIA 25701  
1-866-401-3980 Email: [fpms-lrh@usace.army.mil](mailto:fpms-lrh@usace.army.mil)  
02 October 2015 2:18:20 PM

ID:	1508-1014-3704	DATE IN:	8/10/2015	DATE OUT:	8/13/2015
CONTACT:	Myrtle Lawrence	STATE:	WV		
INTEREST:	Owner and/or Individual	COUNTY:	Lincoln		
PHONE:	304-524-7575	LAT:	38.21032		
REQUEST:	Base Flood Elevation - GIS	LON:	-82.01481		
LOCATION:	208 Sycamore Rd Griffithsville WV 25521				
EXCEPTION:	None noted				

**RESPONSE**

ISSUED BFE:  
699.5 EL FT (NAVD88)

**CALCULATIONS:**

1/9-Arc Second National Elevation Dataset, seamless download,  
<http://nationalmap.usgs.gov>. North American Vertical Datum of 1988  
meters converted to feet by multiplying values by 3.2808399.

Drainage Basin - 1.89 SQ MI  
NSS Crippen & Bue Flood Region "4"  
NSS WV Region "Western"  
PK100: 855.0

EG Slope: 0.012135849  
Mannings N  
Left Channel Bank: 0.05  
Channel: 0.04  
Right Channel Bank: 0.10

WS EL. 699.47

The information provided in this letter reflects FEMA National Flood insurance Program standards. It is recommended that the local floodplain coordinator be contacted for information concerning local policies. Property location was determined from a detailed interview process using the most recent aerial photography.



**US Army Corps  
of Engineers**

**HUNTINGTON DISTRICT, US ARMY CORPS OF ENGINEERS  
FLOODPLAIN MANAGEMENT SERVICES**

502 EIGHTH STREET  
HUNTINGTON, WEST VIRGINIA 25701  
1-866-401-3980 Email: [fpms-lrh@usace.army.mil](mailto:fpms-lrh@usace.army.mil)  
02 October 2015 2:18:20 PM

CONFIDENTIAL PRIVILEGED INFORMATION: The information contained in this communication is confidential and/or privileged, proprietary information that is transmitted solely for the purpose of the intended recipient(s). If the reader of this message is not an intended recipient, or if this message has been inadvertently directed to your attention, you are hereby notified that you have received this communication and any attached document(s) in error, and that any review, dissemination, distribution or copying of this communication is strictly prohibited. If you have received this communication in error, please notify us immediately and destroy all copies of the original communication.

The information obtained from this office is authorized in support of the Federal Emergency Management Agency's (FEMA) National Flood Insurance Program (NFIP) and is authorized by ER 1105-2-100: Planning Guidance Notebook. This information is considered provisional and/or the "best available data" and may be subject to revision. The data is released on the condition that neither the US Army Corps of Engineers nor the United States Government may be held liable for any damages resulting from its use.

Sincerely,

Amy K. Frantz  
Chief, Planning Branch