

ELEVATION CERTIFICATE

Important: Follow the instructions on pages 1-9.

Copy all pages of this Elevation Certificate and all attachments for (1) community official, (2) insurance agent/company, and (3) building owner.

| SECTION A - PROPERTY INFORMATION | | | | FOR INSURANCE COMPANY USE | |
|--|-----------------|-----------------------------------|--|---------------------------|--|
| A1. Building Owner's Name Tyler & Amanda Dolin | | | | Policy Number: | |
| A2. Building Street Address (including Apt., Unit, Suite, and/or Bldg. No.) or P.O. Route and Box No. Rosewood Road | | | | Company NAIC Number: | |
| City Harts | | State West Virginia | | ZIP Code 25524 | |
| A3. Property Description (Lot and Block Numbers, Tax Parcel Number, Legal Description, etc.) Parcel of land on Left Hand Creek approx. 0.1 mile from Big Ugly Creek. | | | | | |
| A4. Building Use (e.g., Residential, Non-Residential, Addition, Accessory, etc.) <u>Residential</u> | | | | | |
| A5. Latitude/Longitude: Lat. <u>38.051375N.</u> Long. <u>82.017310W.</u> Horizontal Datum: <input type="checkbox"/> NAD 1927 <input checked="" type="checkbox"/> NAD 1983 | | | | | |
| A6. Attach at least 2 photographs of the building if the Certificate is being used to obtain flood insurance. | | | | | |
| A7. Building Diagram Number <u>5</u> | | | | | |
| A8. For a building with a crawlspace or enclosure(s): | | | | | |
| a) Square footage of crawlspace or enclosure(s) <u>0</u> sq ft | | | | | |
| b) Number of permanent flood openings in the crawlspace or enclosure(s) within 1.0 foot above adjacent grade <u>0</u> | | | | | |
| c) Total net area of flood openings in A8.b <u>0</u> sq in | | | | | |
| d) Engineered flood openings? <input type="checkbox"/> Yes <input checked="" type="checkbox"/> No | | | | | |
| A9. For a building with an attached garage: | | | | | |
| a) Square footage of attached garage <u>0</u> sq ft | | | | | |
| b) Number of permanent flood openings in the attached garage within 1.0 foot above adjacent grade <u>0</u> | | | | | |
| c) Total net area of flood openings in A9.b <u>0</u> sq in | | | | | |
| d) Engineered flood openings? <input type="checkbox"/> Yes <input checked="" type="checkbox"/> No | | | | | |
| SECTION B - FLOOD INSURANCE RATE MAP (FIRM) INFORMATION | | | | | |
| B1. NFIP Community Name & Community Number Lincoln County, WV / 540088 | | | B2. County Name Lincoln | | B3. State West Virginia |
| B4. Map/Panel Number 54043C0345 | B5. Suffix D | B6. FIRM Index Date 10/16/2013 | B7. FIRM Panel Effective/ Revised Date 10/16/2013 | B8. Flood Zone(s) X | B9. Base Flood Elevation(s) (Zone AO, use Base Flood Depth) 735.7 (SEE NOTES) |
| B10. Indicate the source of the Base Flood Elevation (BFE) data or base flood depth entered in Item B9: <input type="checkbox"/> FIS Profile <input type="checkbox"/> FIRM <input type="checkbox"/> Community Determined <input checked="" type="checkbox"/> Other/Source: <u>USACE Determination</u> | | | | | |
| B11. Indicate elevation datum used for BFE in Item B9: <input type="checkbox"/> NGVD 1929 <input checked="" type="checkbox"/> NAVD 1988 <input type="checkbox"/> Other/Source: _____ | | | | | |
| B12. Is the building located in a Coastal Barrier Resources System (CBRS) area or Otherwise Protected Area (OPA)? <input type="checkbox"/> Yes <input checked="" type="checkbox"/> No Designation Date: _____ <input type="checkbox"/> CBRS <input type="checkbox"/> OPA | | | | | |

ELEVATION CERTIFICATE

OMB No. 1660-0008
Expiration Date: November 30, 2018

| | | | |
|--|------------------------|-------------------|----------------------------------|
| IMPORTANT: In these spaces, copy the corresponding information from Section A. | | | FOR INSURANCE COMPANY USE |
| Building Street Address (including Apt., Unit, Suite, and/or Bldg. No.) or P.O. Route and Box No. Rosewood Road | | | Policy Number: |
| City Harts | State West Virginia | ZIP Code 25524 | Company NAIC Number |

SECTION C – BUILDING ELEVATION INFORMATION (SURVEY REQUIRED)

- C1. Building elevations are based on: ☒ Construction Drawings* ☐ Building Under Construction* ☐ Finished Construction
*A new Elevation Certificate will be required when construction of the building is complete.

- C2. Elevations – Zones A1–A30, AE, AH, A (with BFE), VE, V1–V30, V (with BFE), AR, AR/A, AR/AE, AR/A1–A30, AR/AH, AR/AO. Complete Items C2.a–h below according to the building diagram specified in Item A7. In Puerto Rico only, enter meters.

Benchmark Utilized: Survey grade GPS on site Vertical Datum: NAVD88

Indicate elevation datum used for the elevations in items a) through h) below.

☐ NGVD 1929 ☒ NAVD 1988 ☐ Other/Source: _____

Datum used for building elevations must be the same as that used for the BFE.

Check the measurement used.

- | | | |
|---|--------------|--|
| a) Top of bottom floor (including basement, crawlspace, or enclosure floor) | <u>N/A.</u> | <input checked="" type="checkbox"/> feet <input type="checkbox"/> meters |
| b) Top of the next higher floor | <u>737.7</u> | <input checked="" type="checkbox"/> feet <input type="checkbox"/> meters |
| c) Bottom of the lowest horizontal structural member (V Zones only) | <u>N/A.</u> | <input checked="" type="checkbox"/> feet <input type="checkbox"/> meters |
| d) Attached garage (top of slab) | <u>N/A.</u> | <input checked="" type="checkbox"/> feet <input type="checkbox"/> meters |
| e) Lowest elevation of machinery or equipment servicing the building (Describe type of equipment and location in Comments) | <u>N/A.</u> | <input checked="" type="checkbox"/> feet <input type="checkbox"/> meters |
| f) Lowest adjacent (finished) grade next to building (LAG) | <u>736.0</u> | <input checked="" type="checkbox"/> feet <input type="checkbox"/> meters |
| g) Highest adjacent (finished) grade next to building (HAG) | <u>737.2</u> | <input checked="" type="checkbox"/> feet <input type="checkbox"/> meters |
| h) Lowest adjacent grade at lowest elevation of deck or stairs, including structural support | <u>N/A.</u> | <input checked="" type="checkbox"/> feet <input type="checkbox"/> meters |

SECTION D – SURVEYOR, ENGINEER, OR ARCHITECT CERTIFICATION

This certification is to be signed and sealed by a land surveyor, engineer, or architect authorized by law to certify elevation information. I certify that the information on this Certificate represents my best efforts to interpret the data available. I understand that any false statement may be punishable by fine or imprisonment under 18 U.S. Code, Section 1001.

Were latitude and longitude in Section A provided by a licensed land surveyor? ☒ Yes ☐ No ☐ Check here if attachments.

Certifier's Name
William R. Gunnoe

License Number
801

Title
Registered Professional Surveyor

Company Name
Gunnoe Surveying & Mapping

Address
P.O. Box 1172

City
Clendenin

State
West Virginia

ZIP Code
25045

Signature

William R. Gunnoe

Date
07/12/2017

Telephone
(304) 548-5324



Copy all pages of this Elevation Certificate and all attachments for (1) community official, (2) insurance agent/company, and (3) building owner.

Comments (including type of equipment and location, per C2(e), if applicable)

Item B9 - BFE provided as evidence only. It is understood that no BFE exists outside Zone A. Subject is a proposed mobile home set on piers with breakaway type perforated vinyl skirting, located entirely in Zone X.

ELEVATION CERTIFICATE

OMB No. 1660-0008

Expiration Date: November 30, 2018

IMPORTANT: In these spaces, copy the corresponding information from Section A.**FOR INSURANCE COMPANY USE**Building Street Address (including Apt., Unit, Suite, and/or Bldg. No.) or P.O. Route and Box No.
Rosewood Road

Policy Number:

City
HartsState
West VirginiaZIP Code
25524

Company NAIC Number

**SECTION E – BUILDING ELEVATION INFORMATION (SURVEY NOT REQUIRED)
FOR ZONE AO AND ZONE A (WITHOUT BFE)**

For Zones AO and A (without BFE), complete Items E1–E5. If the Certificate is intended to support a LOMA or LOMR-F request, complete Sections A, B, and C. For Items E1–E4, use natural grade, if available. Check the measurement used. In Puerto Rico only, enter meters.

- E1. Provide elevation information for the following and check the appropriate boxes to show whether the elevation is above or below the highest adjacent grade (HAG) and the lowest adjacent grade (LAG).
- a) Top of bottom floor (including basement, crawlspace, or enclosure) is _____ ☐ feet ☐ meters ☐ above or ☐ below the HAG.
- b) Top of bottom floor (including basement, crawlspace, or enclosure) is _____ ☐ feet ☐ meters ☐ above or ☐ below the LAG.
- E2. For Building Diagrams 6–9 with permanent flood openings provided in Section A Items 8 and/or 9 (see pages 1–2 of Instructions), the next higher floor (elevation C2.b in the diagrams) of the building is _____ ☐ feet ☐ meters ☐ above or ☐ below the HAG.
- E3. Attached garage (top of slab) is _____ ☐ feet ☐ meters ☐ above or ☐ below the HAG.
- E4. Top of platform of machinery and/or equipment servicing the building is _____ ☐ feet ☐ meters ☐ above or ☐ below the HAG.
- E5. Zone AO only: If no flood depth number is available, is the top of the bottom floor elevated in accordance with the community's floodplain management ordinance? ☐ Yes ☐ No ☐ Unknown. The local official must certify this information in Section G.

SECTION F – PROPERTY OWNER (OR OWNER'S REPRESENTATIVE) CERTIFICATION

The property owner or owner's authorized representative who completes Sections A, B, and E for Zone A (without a FEMA-issued or community-issued BFE) or Zone AO must sign here. The statements in Sections A, B, and E are correct to the best of my knowledge.

Property Owner or Owner's Authorized Representative's Name

Address

City

State

ZIP Code

Signature

Date

Telephone

Comments

☐ Check here if attachments.

ELEVATION CERTIFICATEOMB No. 1660-0008
Expiration Date: November 30, 2018**IMPORTANT: In these spaces, copy the corresponding information from Section A.****FOR INSURANCE COMPANY USE**Building Street Address (including Apt., Unit, Suite, and/or Bldg. No.) or P.O. Route and Box No.
Rosewood Road

Policy Number:

City
HartsState
West VirginiaZIP Code
25524

Company NAIC Number

SECTION G – COMMUNITY INFORMATION (OPTIONAL)

The local official who is authorized by law or ordinance to administer the community's floodplain management ordinance can complete Sections A, B, C (or E), and G of this Elevation Certificate. Complete the applicable item(s) and sign below. Check the measurement used in Items G8–G10. In Puerto Rico only, enter meters.

- G1. ☐ The information in Section C was taken from other documentation that has been signed and sealed by a licensed surveyor, engineer, or architect who is authorized by law to certify elevation information. (Indicate the source and date of the elevation data in the Comments area below.)
- G2. ☐ A community official completed Section E for a building located in Zone A (without a FEMA-issued or community-issued BFE) or Zone AO.
- G3. ☐ The following information (Items G4–G10) is provided for community floodplain management purposes.

G4. Permit Number

G5. Date Permit Issued

G6. Date Certificate of
Compliance/Occupancy IssuedG7. This permit has been issued for: ☐ New Construction ☐ Substantial ImprovementG8. Elevation of as-built lowest floor (including basement)
of the building: _____ ☐ feet ☐ meters Datum _____G9. BFE or (in Zone AO) depth of flooding at the building site: _____ ☐ feet ☐ meters Datum _____G10. Community's design flood elevation: _____ ☐ feet ☐ meters Datum _____

Local Official's Name

Title

Community Name

Telephone

Signature

Date

Comments (including type of equipment and location, per C2(e), if applicable)

☐ Check here if attachments.

ELEVATION CERTIFICATE**BUILDING PHOTOGRAPHS**

See Instructions for Item A6.

OMB No. 1660-0008

Expiration Date: November 30, 2018

IMPORTANT: In these spaces, copy the corresponding information from Section A.**FOR INSURANCE COMPANY USE**Building Street Address (including Apt., Unit, Suite, and/or Bldg. No.) or P.O. Route and Box No.
Rosewood Road

Policy Number:

City
HartsState
West VirginiaZIP Code
25524

Company NAIC Number

If using the Elevation Certificate to obtain NFIP flood insurance, affix at least 2 building photographs below according to the instructions for Item A6. Identify all photographs with date taken; "Front View" and "Rear View"; and, if required, "Right Side View" and "Left Side View." When applicable, photographs must show the foundation with representative examples of the flood openings or vents, as indicated in Section A8. If submitting more photographs than will fit on this page, use the Continuation Page.

Photo One

Photo One

Photo One Caption

Photo Two

Photo Two

Photo Two Caption

ELEVATION CERTIFICATE**BUILDING PHOTOGRAPHS**

Continuation Page

OMB No. 1660-0008

Expiration Date: November 30, 2018

IMPORTANT: In these spaces, copy the corresponding information from Section A.**FOR INSURANCE COMPANY USE**Building Street Address (including Apt., Unit, Suite, and/or Bldg. No.) or P.O. Route and Box No.
Rosewood Road

Policy Number:

City
HartsState
West VirginiaZIP Code
25524

Company NAIC Number

If submitting more photographs than will fit on the preceding page, affix the additional photographs below. Identify all photographs with: date taken; "Front View" and "Rear View"; and, if required, "Right Side View" and "Left Side View." When applicable, photographs must show the foundation with representative examples of the flood openings or vents, as indicated in Section A8.

Photo One

Photo One

Photo One Caption

Photo Two

Photo Two

Photo Two Caption

FIRM 54043C0345D

BFE = 735.7

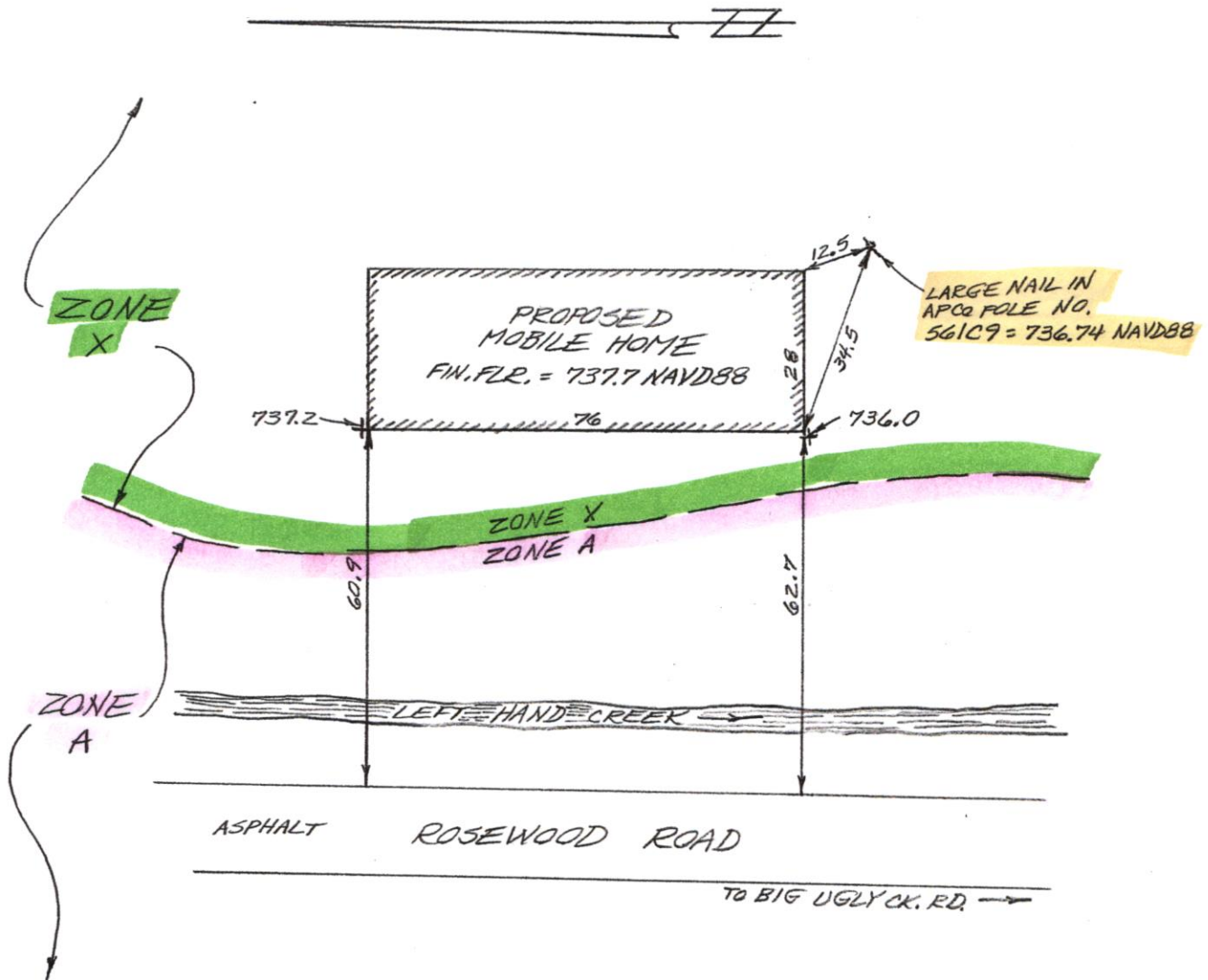

SKETCH SHOWING
PROPOSED MOBILE HOME
ON LEFT HAND CREEK OF BIG UGLY CREEK
HARTS CREEK DISTRICT, LINCOLN COUNTY,
WEST VIRGINIA
PREPARED FOR
TYLER DOLIN
SCALE: 1" = 30' JULY 12, 2017

WILLIAM R. GUNNOE
LICENSED
NO. 84
STATE OF
REGISTERED PROFESSIONAL SURVEYOR NO. 801
CLANDENIN, WV