

FOR TAX PURPOSES ONLY

Prepared By:  
**Norb Netzel**  
 Monroe County Assessor

**Legend**

Property Line	—	Original Lot Line	- - - - -
Road Right of Way	—	Lot Number	(15)
Corporation Line	—	Parcel Number	(99)
District Line	—	Water	· · · · ·
County Line	—	Railroad	—+—+—+—

R	1	Revised 3/1/15	9	17
O	2	Revised 3/1/16	10	18
V	3	Revised 12/30/2016	11	19
J	4		12	20
S	5		13	21
I	6		14	22
O	7		15	23
N	8		16	24

**STATE OF WEST VIRGINIA**  
**COUNTY OF MONROE**  
 Office of Assessor

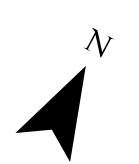
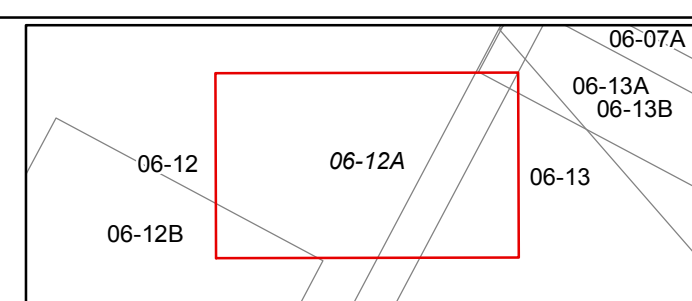

SWEET SPRINGS  
 Map: 12A  
 Date, Aerial Photography: 2003  
 Date, Map: 1/25/2017  
 Scale: 1" = 100'