

FOR TAX PURPOSES ONLY

Prepared By:

Norb Netzel
Monroe County Assessor

Legend	
Property Line	Original Lot Line
Road Right of Way	Lot Number (15)
Corporation Line	Parcel Number (99)
District Line	Water
County Line	Railroad

R	1	Revised 3/1/15	9		17
O	2	Revised 3/1/16	10		18
V	3	Revised 12/30/2016	11		19
J	4		12		20
S	5		13		21
I	6		14		22
O	7		15		23
N	8		16		24

STATE OF WEST VIRGINIA
COUNTY OF MONROE
Office of Assessor

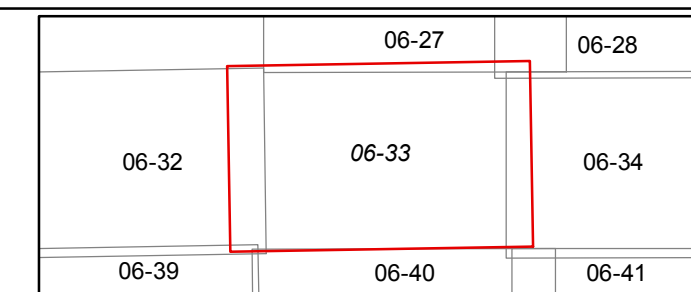

SWEET SPRINGS

Map: 33

Date, Aerial Photography: 2003

Date, Map: 1/25/2017

Scale: 1" = 400'