

FOR TAX PURPOSES ONLY
 Prepared By:
Connie Ervin
 Preston County Assessor

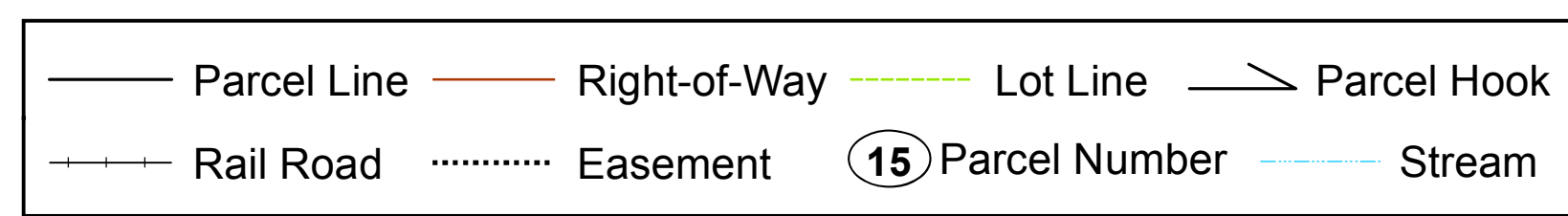

PRESTON COUNTY - WEST VIRGINIA
 Restriction
Reproduction of Tax Maps Prohibited by Law
 No person may reproduce, modify, copy, distribute or sell copies of tax maps prepared by the county without having first obtained written permission of the County Assessor

04-7	04-8	04-9	04-10	04-11	04-12
04-13	04-14	04-15	04-16	04-17	04-18
04-19	04-20	04-21	04-22	04-23	04-24

District: 05 Union
 Map No: 14
 Date: 07/01/14
 Scale: 1" = 400'