

GLADE RUN

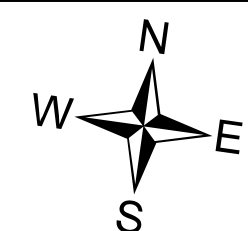

**FOR TAX PURPOSES ONLY**  
Prepared By:  
**Connie Ervin**  
Preston County Assessor

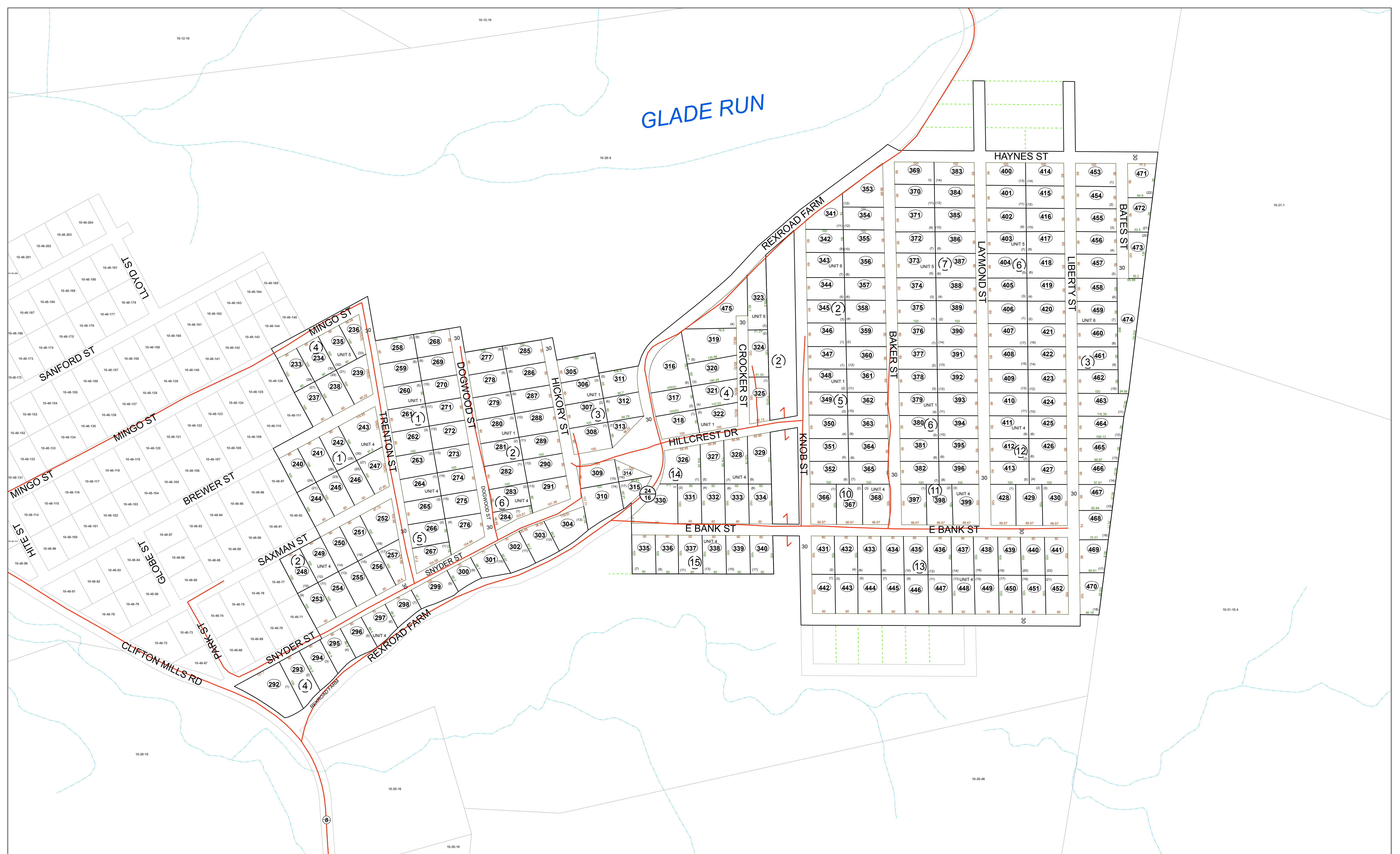
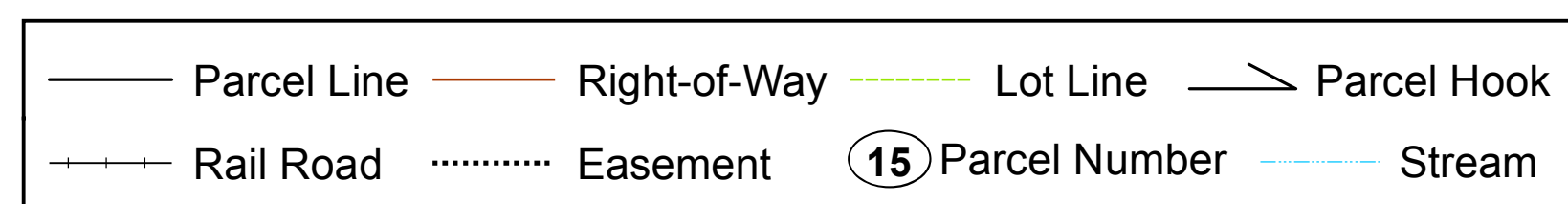

**PRESTON COUNTY - WEST VIRGINIA**  
Restriction  
**Reproduction of Tax Maps Prohibited by Law**

No person may reproduce, modify, copy, distribute or sell copies of tax maps prepared by the county without having first obtained written permission of the County Assessor

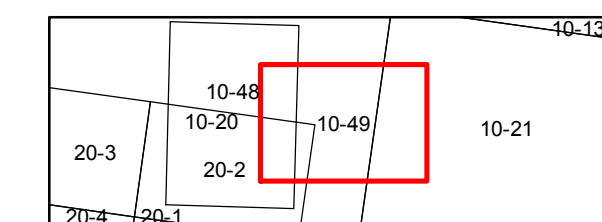

District: 10 Grant  
Map No: 49  
Date: 07/01/14  
Scale: 1" = 100'