

CHEAT RIVER

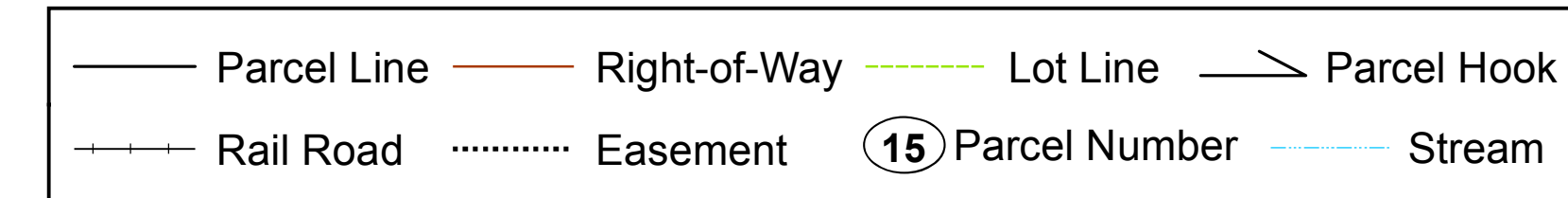

PRESTON COUNTY - WEST VIRGINIA
Restriction
Reproduction of Tax Maps Prohibited by Law
No person may reproduce, modify, copy, distribute or sell copies of tax maps prepared by the county without having first obtained written permission of the County Assessor

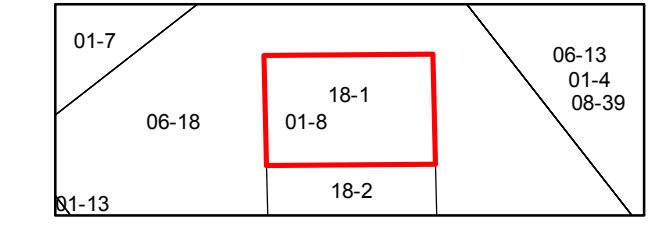

District: 18 Albright
Map No: 1
Date: 07/01/14
Scale: 1" = 100'

FOR TAX PURPOSES ONLY
Prepared By:
Connie Ervin
Preston County Assessor

