

05

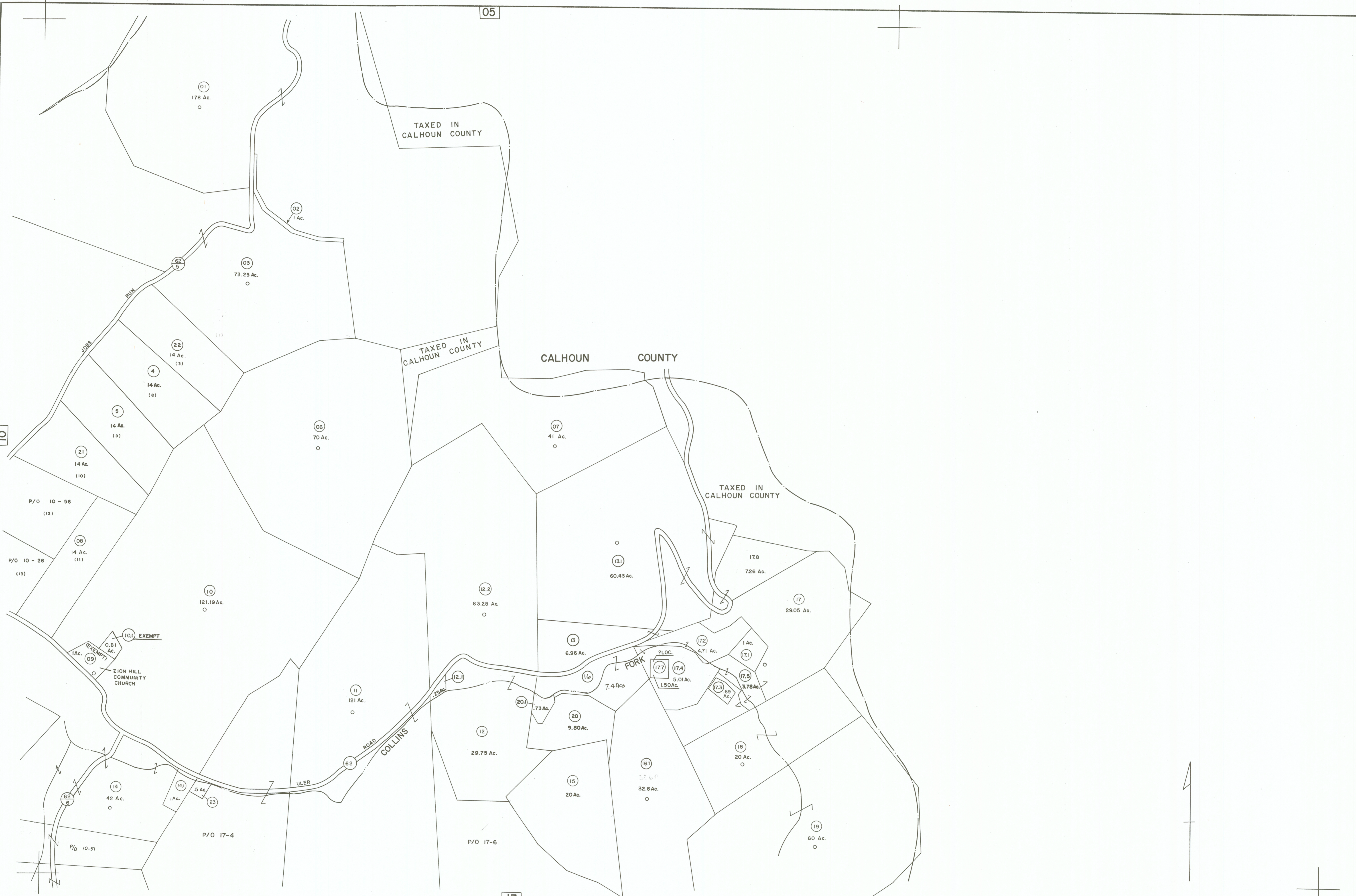

10

17

FOR TAX PURPOSES ONLY

Prepared by  
**L. ROBERT KIMBALL**  
 Consulting Engineer  
 Ebensburg, Pennsylvania

LEGEND

Property line	-----	Original lot line	-----
Edge of pavement or roadway	-----	Deed lot number in parenthesis	(15)
Corporation line	-----	Parcel or index number in circle	(99)
District line	-----	Improvement	o
County line	-----	Railroad	+++++

REVISIONS

1	4-8-80	NCS	9	7/2/04	S&H	17
2	REV. TO 7-1-82	NCS	10	6/22/05	S&H	18
3	REV. TO 7-83	MEN	11	10/7/08	S&H	19
4	To 7/1/87		12	4/22/11	S&H	20
5	EXCALIBUR	2/99	13	2/22/16	S&H	21
6	1/18/2000	S&H	14			22
7	3/11/2001	S&H	15			23
8	3/8/2002	S&H	16			24

STATE OF WEST VIRGINIA  
 COUNTY OF ROANE  
 Office of Assessor

GEARY DISTRICT  
 SHEET II

Date, Aerial Photography: APRIL, 1960 Date, Map: JAN, 1961  
 Photo No: 12-75 Scale: 1"=400'