

THIS DOCUMENT IS A TAX MAP: It was compiled for purposes of taxation from available record evidence and has not been field verified. This map is not a valid survey plat. The existence of data on this document does not imply any "official" status to such data. The W.V. State Tax Dept. and the Hancock County Assessor's Office assume no liability that might result from use of this document.

Property Line	Original Lot Line	Lot Number	Parcel Number	Water	Railroad	Home/Commercial Building
---	---	(15)	(99)	---	---	●

Revisions	Revised	Revised	Revised	Revised	Revised	Revised
1	07/20/2020	9	17			
2	2/9/2021	10	18			
3	1/25/2022	11	19			
4	1/9/2023	12	20			
5	1/18/2024	13	21			
6	1/24/2025	14	22			
7		15	23			
8		16	24			

STATE OF WEST VIRGINIA
HANCOCK COUNTY ASSESSOR
 New Cumberland, West Virginia
 Joseph M. Alongi, Assessor

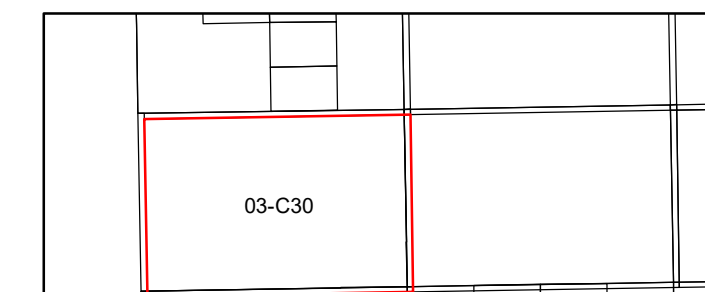

CLAY
 Map: C30
 Date, Aerial Photography: 2003
 Date, Map: 1/24/2025
 Scale: 1" = 400'