

**FOR TAX PURPOSES ONLY**  
**LANDMARK**  
 geospatial

Legend	
	District Boundary
	Previous Deed
	Property
	Road Easement
	Railroad Right of Way
	Road Right of Way
	River
	Deed lot Number (15)
	Parcel or Index Number (9)
	UNKNOWN
	Improvement
	Cemetery
	School
	Church

**Restriction**

All tax maps created under the provisions of reappraisal legislation are the property of the Assessor of Randolph County, West Virginia and the reproduction, copying, modification, distribution or sale of such tax maps or any copies thereof without the written permission of the Randolph County Assessor is prohibited by law.

Revisions			
1	6-30-1964	10	OGIS J.E.B. 4-20-1995
2	T.R.L. 11-19-1980	11	SLS INC. J.W.M. 3-1997
3	D.F. 7-1-1983	12	P.K.Y. 7-1-2000
4	N.C.S. 7-1-1984	13	P.K.Y. 7-1-2002
5	R.E.B. 7-1-1988	14	P.K.Y. 7-1-2004
6	D.F. 7-1-1989	15	A.K.B. 7-1-2005
7	OGIS 3-4-1991	16	A.K.B. 7-1-2009
8	OGIS T.L. 4-30-1992	17	S.T.P. 7-1-2013
9	OGIS J.E.B. 3-15-1994	18	S.T.P. 7-1-2014
19	S.T.P. 7-1-2015	28	
20	S.T.P. 7-1-2016	29	
21	S.T.P. 5-18-2017	30	
22		31	
		32	
		33	
		34	
		35	
		36	

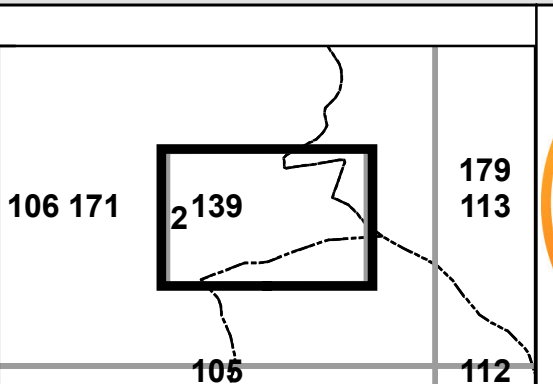

**RANDOLPH COUNTY**  
 Assessor's Office  
 Phyllis K. Yokum, Assessor  
 ELKINS, WV

**BEVERLY**  
 District 02 Map No. 2  
 Date of Publication: 2/3/2025  
 Scale: 1"=100'