

FOR TAX PURPOSES ONLY
LANDMARK
 geospatial

Legend	
	District Boundary
	Previous Deed
	Property
	Road Easement
	Railroad Right of Way
	Road Right of Way
	River
	Deed lot Number (15)
	Parcel or Index Number (9)
	UNKNOWN
	Improvement
	Cemetery
	School
	Church

Restriction

All tax maps created under the provisions of reappraisal legislation are the property of the Assessor of Randolph County, West Virginia and the reproduction, copying, modification, distribution or sale of such tax maps or any copies thereof without the written permission of the Randolph County Assessor is prohibited by law.

Revisions			
1	6-30-1964	10	OGIS S.A.J. 2-21-1991
2	D.F. 7-1980	11	OGIS T.L. 4-30-1992
3	D.F. 7-1-1983	12	OGIS T.R.L. 5-6-1993
4	C.P. 7-1-1984	13	OGIS J.E.B. 3-15-1994
5	T.R.L. 7-1985	14	OGIS J.E.B. 4-20-1995
6	T.R.L. 7-1986	15	OGIS J.E.B. 5-1-1996
7	D.F. 7-1-1987	16	SLS INC. J.W.M. 3-1997
8	R.E.B. 7-1-1988	17	P.K.Y. 7-1-1998
9	D.F. 7-1-1989	18	P.K.Y. 7-1-1999
19	P.K.Y. 7-1-2000	28	
20	P.K.Y. 7-1-2001	29	
21	P.K.Y. 7-1-2003	30	
22	P.K.Y. 7-1-2004	31	
23	A.K.B. 7-1-2005	32	
24	A.K.B. 7-1-2007	33	
25	A.K.B. 7-1-2009	34	
26	S.T.P. 7-1-2015	35	
27	S.T.P. 5-18-2017	36	

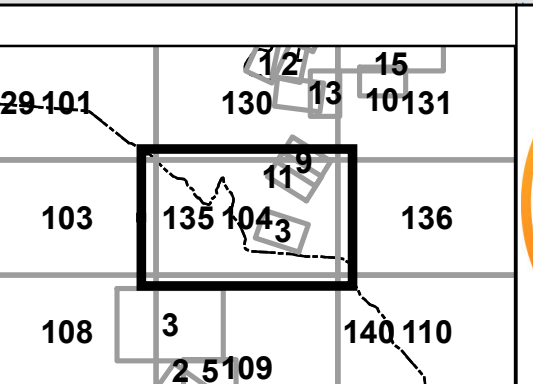

RANDOLPH COUNTY BEVERLY
 Assessor's Office
 Phyllis K. Yokum, Assessor
 ELKINS, WV

District 02 Map No. 135
 Date of Publication: 2/3/2025
 Scale: 1"=400'