

Legend	
	District Boundary
	Previous Deed
	Property
	Road Easement
	Railroad Right of Way
	Road Right of Way
	River
	Deed lot Number (15)
	Parcel or Index Number (9)
	UNKNOWN
	Improvement
	Cemetery
	School
	Church

Restriction

All tax maps created under the provisions of reappraisal legislation are the property of the Assessor of Randolph County, West Virginia and the reproduction, copying, modification, distribution or sale of such tax maps or any copies thereof without the written permission of the Randolph County Assessor is prohibited by law.

Revisions			
1	6-30-1964	10	OGIS J.E.B. 5-1-1996
2	D.R. 7-1980	11	P.K.Y. 7-1-1998
3	N.S. 3-1981	12	P.K.Y. 7-1-1999
4	L.E.S. 7-1-1983	13	A.K.B. 7-1-2007
5	T.R.L. 7-1984	14	A.K.B. 7-1-2008
6	N.C.S. 7-1-1986	15	A.S.T. 7-1-2011
7	OGIS 3-2-1991	16	
8	OGIS J.E.B. 4-15-1992	17	
9	OGIS S.A.J. 5-2-1993	18	
		19	
		20	
		21	
		22	
		23	
		24	
		25	
		26	
		27	
		28	
		29	
		30	
		31	
		32	
		33	
		34	
		35	
		36	

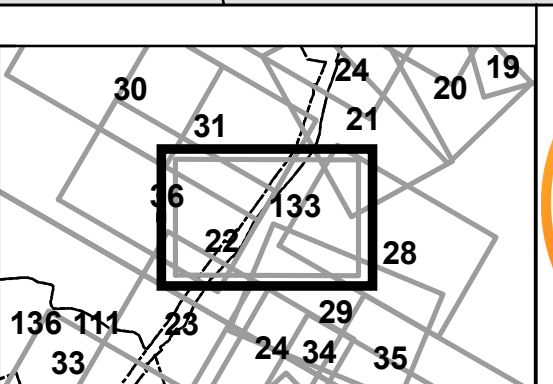

RANDOLPH COUNTY
 Assessor's Office
 Phyllis K. Yokum, Assessor
 ELKINS, WV

LEADSVILLE
 District 10 Map No. 22
 Date of Publication: 2/3/2025
 Scale: 1"=100'