

FOR TAX PURPOSES ONLY
LANDMARK
 geospatial

Legend	
	District Boundary
	Previous Deed
	Property
	Road Easement
	Railroad Right of Way
	Road Right of Way
	River
	Deed lot Number (15)
	Parcel or Index Number (9)
	UNKNOWN
	Improvement
	Cemetery
	School
	Church

Restriction

All tax maps created under the provisions of reappraisal legislation are the property of the Assessor of Randolph County, West Virginia and the reproduction, copying, modification or sale of such tax maps or any copies thereof without the written permission of the Randolph County Assessor is prohibited by law.

Revisions			
1	OGIS J.E.B. 4-15-1992	10	28
2	OGIS R.R.O. 3-1994	11	29
3	OGIS J.E.B. 4-20-1995	12	30
4	OGIS J.E.B. 5-1-1996	13	31
5	SLS INC. J.W.M. 4-1997	14	32
6	P.K.Y. 7-1-2000	15	33
7	P.K.Y. 7-1-2001	16	34
8		17	35
9		18	36
		19	27
		20	28
		21	29
		22	30
		23	31
		24	32
		25	33
		26	34
		27	35
		28	36

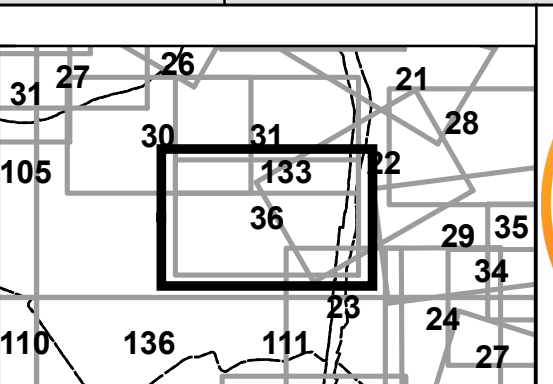

RANDOLPH COUNTY LEADSVILLE
 Assessor's Office
 Phyllis K. Yokum, Assessor
 ELKINS, WV

District 10 Map No. 36
 Date of Publication: 2/3/2025
 Scale: 1"=100'